

A0 INSTALLATION DRAWING

IF THIS DOCUMENT IS PRINTED IN HARDCOPY, IT IS FOR INFORMATION USE ONLY AND THEREFORE IS NOT SUBJECT TO UPDATING CONTROLS. ALWAYS REFER TO SOLIDWORKS VIEWER FOR LATEST ISSUE

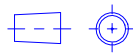

FIRST ANGLE PROJECTION

THIS DRAWING IS CONFIDENTIAL AND IS SUPPLIED ON THE EXPRESS CONDITION THAT IT SHALL NOT BE LOANED OR COPIED OR DISCLOSED TO ANY OTHER PERSON OR USED FOR ANY OTHER PURPOSE WITHOUT THE WRITTEN CONSENT OF AP RACING LTD.



© AP Racing Ltd. 2000

AP Racing
Wheler Road
Coventry
CV3 4LB

Tel: +44 024 7663 9595 e-mail: sales@apracing.co.uk
Fax: +44 024 7663 9559 Web site: HTTP://www.apracing.com

Alterations				
Issue No	Date & No.	Particulars	Zone	Initials
1	23/05/03 B3658	FIRST ISSUE		SAT
2	15/07/03	Ø320 RADIAL PROFILE ADDED	SH2	SAT
3	12/08/03 B3720	STAINLESS STEEL PISTONS ADDED AS ALTERNATIVE OPTION		SAT

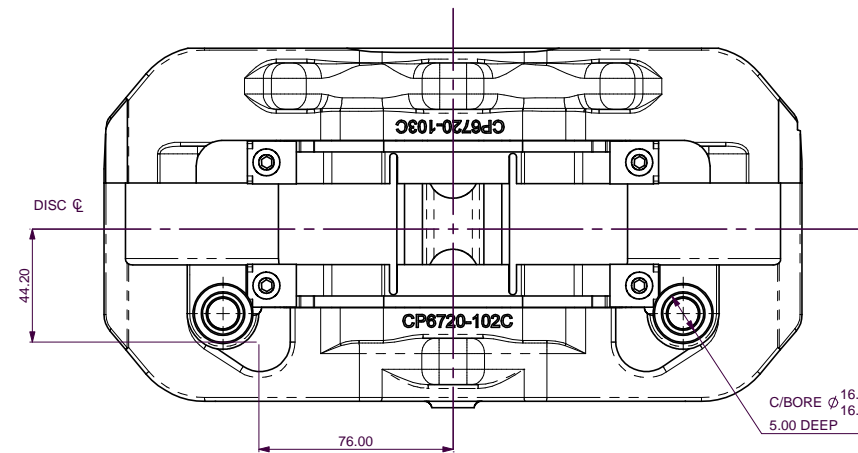
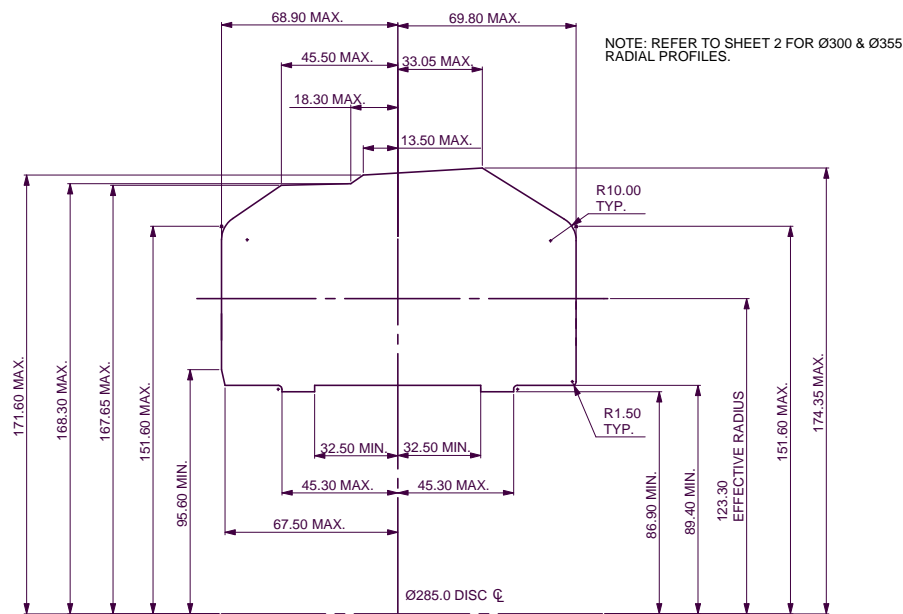
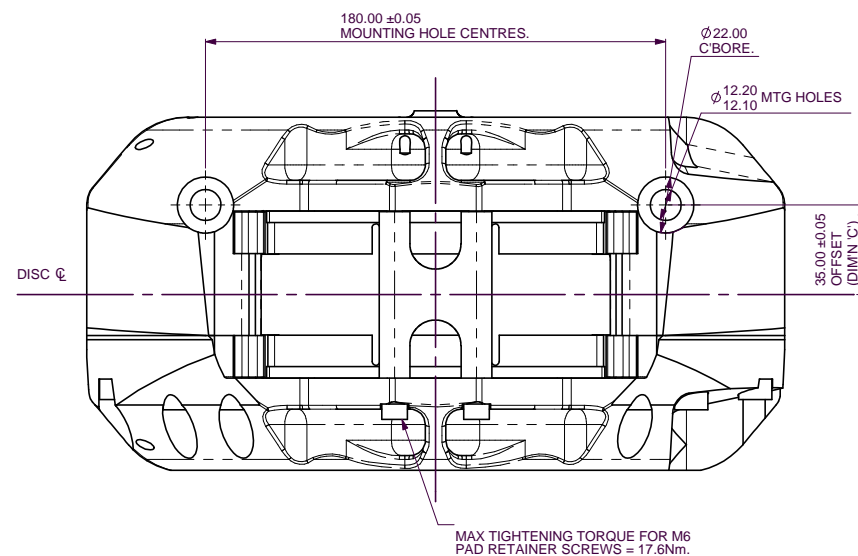
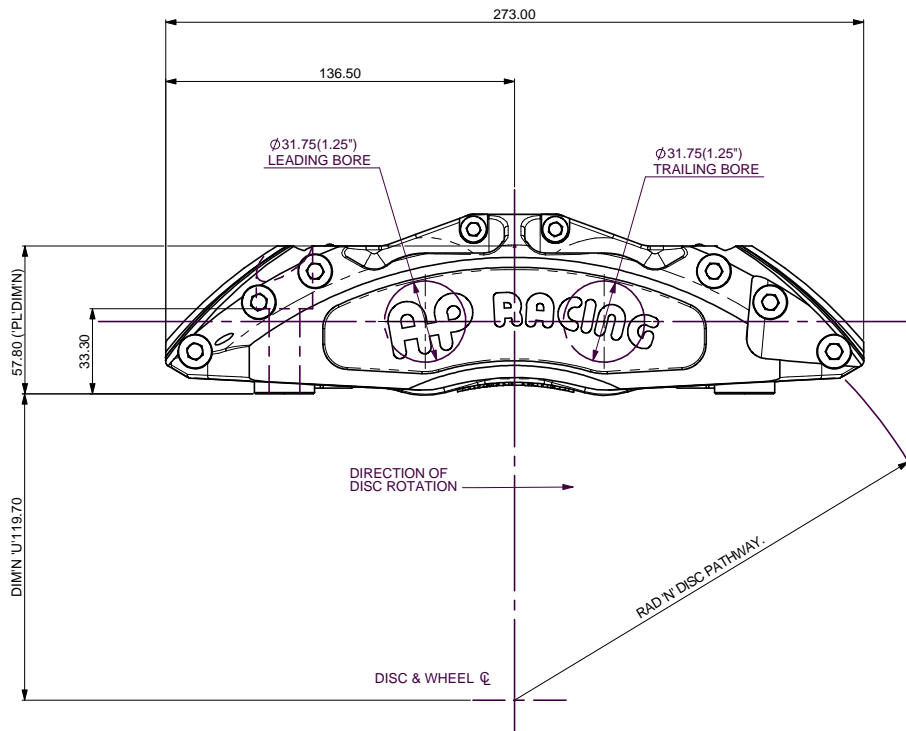
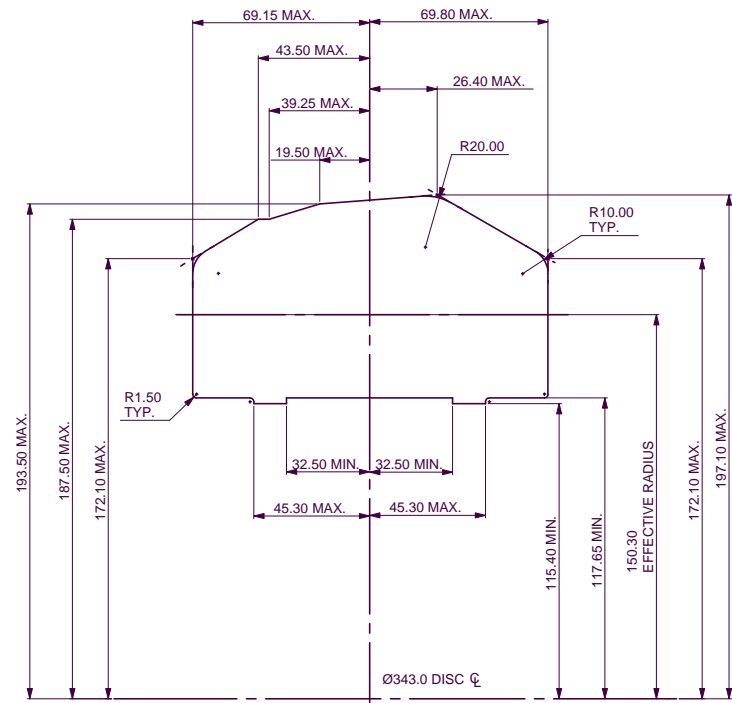
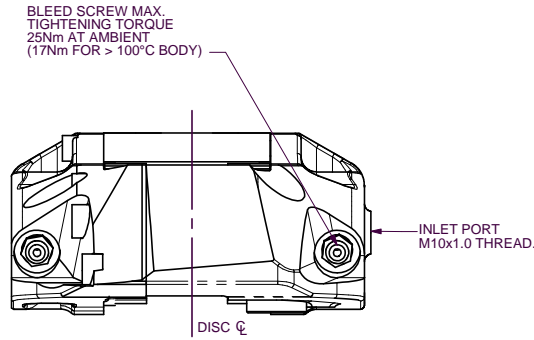

GENERAL DESCRIPTION:
THIS IS A 4 PISTON EQUAL BORE CALIPER DESIGNED TO OPERATE ON A VENTILATED IRON DISC OF Ø300.0 UP TO Ø355.0mm X 28.0mm. STAINLESS STEEL PAD ABUTMENT WEAR PLATES ARE FITTED. SEALS ARE HIGH TEMPERATURE 'SEAL-IN-BORE' TYPE, WITH A HIGH TEMP BOOT TYPE DIRT SEAL.

TYPICAL APPLICATION:
RALLY

TECHNICAL INFORMATION:
TOTAL PISTON AREA: 31.67cm²
PISTON MATERIAL: ALUMINIUM ALLOY OR STAINLESS STEEL - SEE PART No.
BODY MATERIAL: ALUMINIUM ALLOY
APPROXIMATE WEIGHT OF CALIPER LESS PADS : 2.66 Kg
HYDRAULIC CONNECTIONS: M10x1.0
BRAKE PADS: CP3215 FAMILY PAD

INSTALLATION INFORMATION
DISC & CALIPER MOUNTING TOLERANCES TO BE SUCH THAT THE DISC IS CENTRAL TO THE CALIPER TO WITHIN ±0.5mm.
DISC DIAMETRICAL CLEARANCE SHOULD BE 2.5mm NOM. FROM DISC O.D. TO PATHWAY. THE O.D. CLEARANCE CAN BE REDUCED TO 1.8mm MIN. FOR SMALL DIA. DISCS (Ø280.0mm & LOWER).
BLEED SCREW MAX. TIGHTENING TORQUE 25Nm AT AMBIENT (17Nm FOR >100°C BODY).
MAX. TIGHTENING TORQUE FOR M6 PAD RETAINER SCREWS = 17.6Nm.

KEY TO DIMENSIONS:
DIMENSION 'PL': TOP OF PAD MATERIAL TO MOUNTING BOSS FACE WITH PAD SITTING DOWN ON LEDGE.
DIMENSION 'U': WHEEL CENTRE LINE TO CALIPER MOUNTING BOSS FACE (DISC Ø/2)-DIMENSION 'PL'.
DIMENSION 'C': OFFSET-DISC CENTRE LINE TO MOUNTING HOLES.
EFFECTIVE RAD: DISTANCE FROM WHEEL CENTRE LINE TO NOMINAL PISTON CENTRE LINE.

AP RACING TECHNICAL SECTION WILL BE PLEASED TO ADVISE ON THE MOST SUITABLE EQUIPMENT FOR ANY PARTICULAR APPLICATION.

CALIPER PART NUMBERS

- CP6740-2S4 - RIGHT HAND TRAILING & LEFT HAND LEADING (ALU. ALLOY PISTON)
- CP6740-2S4L - RIGHT HAND TRAILING & LEFT HAND LEADING (SST. PISTON)
- CP6740-3S4 - LEFT HAND TRAILING & RIGHT HAND LEADING (ALU. ALLOY PISTON)
- CP6740-3S4L - LEFT HAND TRAILING & RIGHT HAND LEADING (SST. PISTON)

REPLACEMENT SEAL KIT

SEAL KIT (HIGH TEMP) CP4518-EE:RALLY

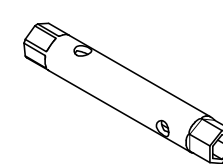
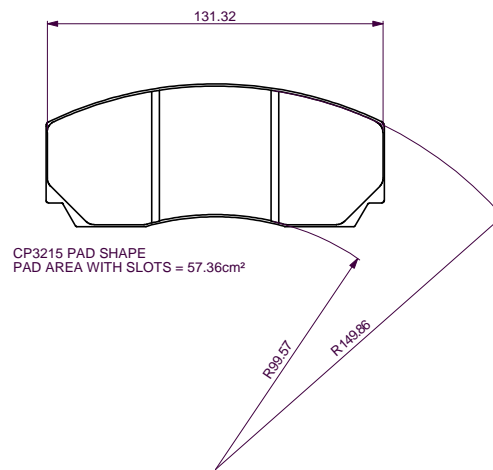

BLEEDING
A TOOL SIMILAR TO THAT SHOWN WILL BE REQUIRED TO BLEED THE BRAKES DUE TO THE ENCLOSED BLEED SCREWS. IT IS IMPORTANT THAT THE BOX WRENCH IS HOLLOW TO ALLOW A LENGTH OF BLEED PIPE TO BE INSERTED THROUGH THE TOOL. TOOL MAX. Ø17.50.

CALIPER DATA

CALIPER FAMILY No	STROKE No				DISC DIAMETER Ø	DIMN 'E' DISC WIDTH MAX	PAD THICKNESS (mm)	EFF RAD (mm)	RAD 'N' (mm)
	RHT	LHT	RHL	LHL					
CP6740-	2	3	4	5	355.0	28.0	16.8	152.1	180.0
CP6740-	2	3	4	5	343.0	28.0	16.8	150.3	180.0
CP6740-	2	3	4	5	300.0	28.0	16.8	125.4	180.0
CP6740-	2	3	4	5	285.0	28.0	16.8	123.3	180.0

SCALE 1:1 SHEET 1 OF 2

DRAWN Steve Thomas

APPROVED

DERIVED FROM

TITLE
4 POT 2-PIECE 1.25" & 1.25"
CALIPER INSTALLATION

DRG NO. cp6740-1cd

A0 INSTALLATION DRAWING

IF THIS DOCUMENT IS PRINTED IN HARD COPY, IT IS FOR INFORMATION USE ONLY AND THEREFORE IS NOT SUBJECT TO UPDATING CONTROLS. ALWAYS REFER TO SOLIDWORKS VIEWER FOR LATEST ISSUE

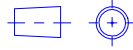

FIRST ANGLE PROJECTION

THIS DRAWING IS CONFIDENTIAL AND IS SUPPLIED ON THE EXPRESS CONDITION THAT IT SHALL NOT BE LOANED OR COPIED OR DISCLOSED TO ANY OTHER PERSON OR USED FOR ANY OTHER PURPOSE WITHOUT THE WRITTEN CONSENT OF AP RACING LTD.



© AP Racing Ltd. 2001

AP Racing
Wheler Road
Coventry
CV3 4LB

Tel: +44 024 7663 9595 e-mail: sales@apracing.co.uk
Fax: +44 024 7663 9559 Web site: HTTP://www.apracing.com

Alterations			
Issue No	Date & No.	Particulars	Zone

SEE SHEET 1 FOR CURRENT ISSUE.

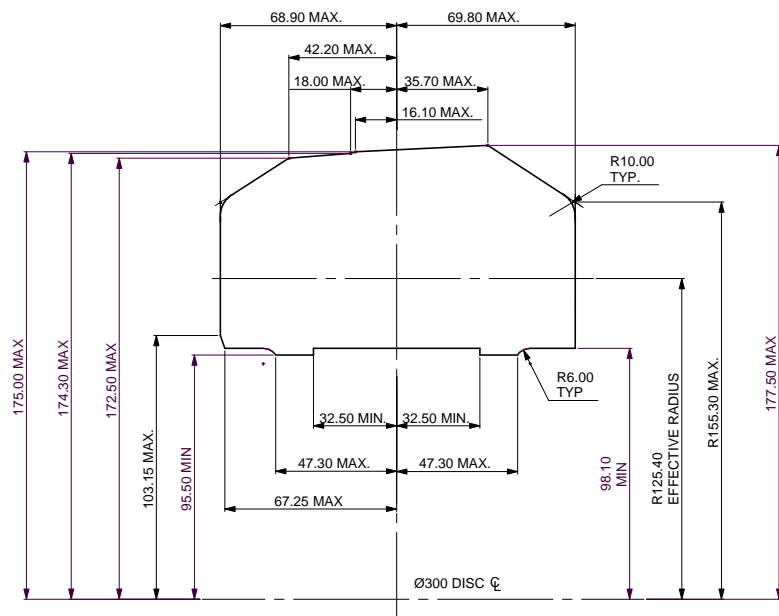
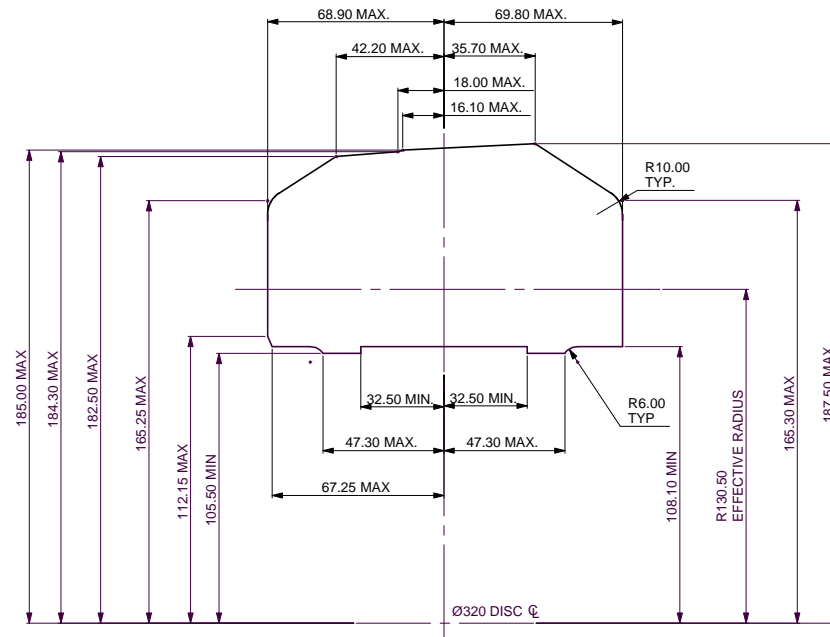
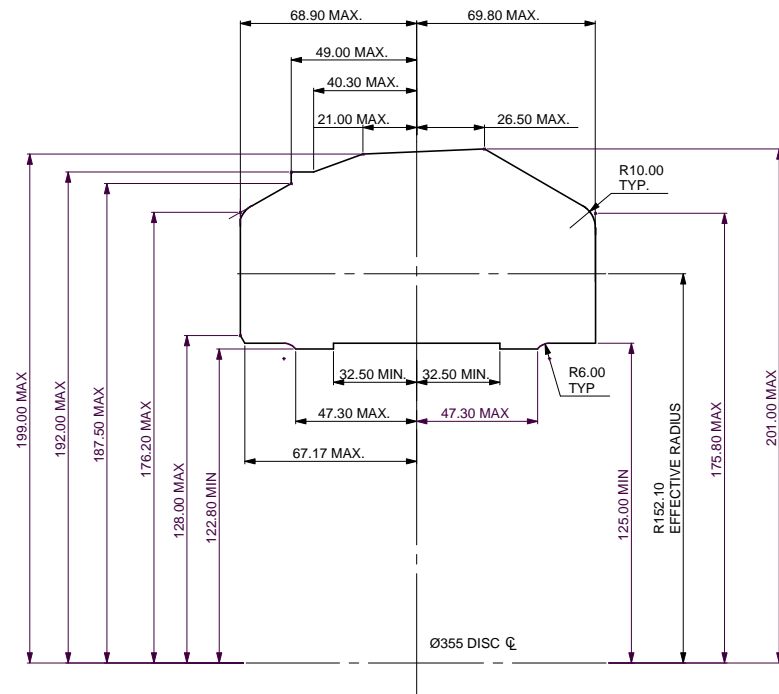

SCALE 1:1 SHEET 2 OF 2

DRAWN Steve Thomas

APPROVED

DERIVED FROM

TITLE
4 POT 2-PIECE 1.25" & 1.25"
CALIPER INSTALLATION

DRG NO. cp6740-1cd