

A1 INSTALLATION DRAWING

IF THIS DOCUMENT IS PRINTED IN HARDCOPY, IT IS FOR INFORMATION USE ONLY AND THEREFORE IS NOT SUBJECT TO UPDATING CONTROLS. ALWAYS REFER TO SOLIDWORKS VIEWER FOR LATEST ISSUE



THIS DRAWING IS CONFIDENTIAL AND IS SUPPLIED ON THE EXPRESS CONDITION THAT IT SHALL NOT BE LOANED OR COPIED OR DISCLOSED TO ANY OTHER PERSON OR USED FOR ANY OTHER PURPOSE WITHOUT THE WRITTEN CONSENT OF AP RACING LTD.



AP Racing
Wheler Road
Coventry
CV3 4LB

Tel: +44 (0) 24 7663 9595
Fax: +44 (0) 24 7663 9559
e-mail: engineering@apracings.com
Web site: <http://www.apracings.com>

© AP Racing Ltd. 2005

DISC PART NUMBERS:

CP5772-1558 RH AS SHOWN
CP5772-1559 LH OPPOSITE

THIS IS A 72 VANES DISC OF MASS 5.25g

THIS DISC WAS DESIGNED TO WORK WITH A D46 DEPTH PAD.

USE CP2494-504MP BOBBINS TO ACHIEVE 0.45/0.35mm STANDARD FLOAT

FOR DISC MOUNTING TECHNIQUES, BEDDING PROCEDURE AND DISC COOLING RECOMMENDATIONS SEE AP RACING BRAKE DISC CATALOGUE.

DISC INSTALLATION

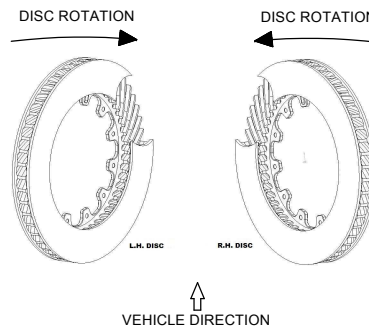

DISC ROTATION

A

8 SLOTS EQUISPACED ON A PCD 8.54"
CHAMF 0.02 x 45° BOTH SIDES

CG8 GROOVE PATTERN

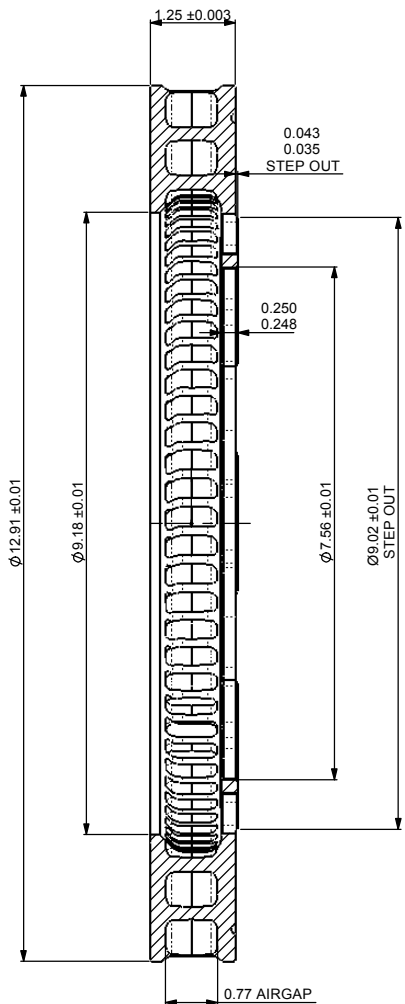

A-A

ISSUE NO.	Alterations			Zone	Initials
	Date & No.	Particulars			
1	13/11/06	FIRST ISSUE			SAT
2	19/03/07	DIM 0.043/0.035 WAS 0.01/0.00			3J SAT
3	28/03/07 B4431	Ø9.02" WAS Ø9.10"			4F SAT

SCALE 1:1	SHEET 1 OF 1
DRAWN	Steve Thomas
APPROVED	
DERIVED FROM	CP3581-1558/1559
TITLE VENTED DISC	
DRG NO.	CP5772-1558/1559