

A1 INSTALLATION DRAWING

IF THIS DOCUMENT IS PRINTED IN HARDCOPY, IT IS FOR INFORMATION USE ONLY AND THEREFORE IS NOT SUBJECT TO UPDATING CONTROLS. ALWAYS REFER TO SOLIDWORKS VIEWER FOR LATEST ISSUE



THIS DRAWING IS CONFIDENTIAL AND IS SUPPLIED ON THE EXPRESS CONDITION THAT IT SHALL NOT BE LOANED OR COPIED OR DISCLOSED TO ANY OTHER PERSON OR USED FOR ANY OTHER PURPOSE WITHOUT THE WRITTEN CONSENT OF AP RACING LTD.



AP Racing
Wheler Road
Coventry
CV3 4LB

Tel: +44 (0) 24 7663 9595
Fax: +44 (0) 24 7663 9556
e-mail: engineering@apracings.co.uk
Web site: <http://www.apracings.com>

© AP Racing Ltd. 2016

12 MOUNTING HOLES Ø8.15/8.05

AS SHOWN

EQUI-SPACED

Ø214.00 P.C.

±0.05

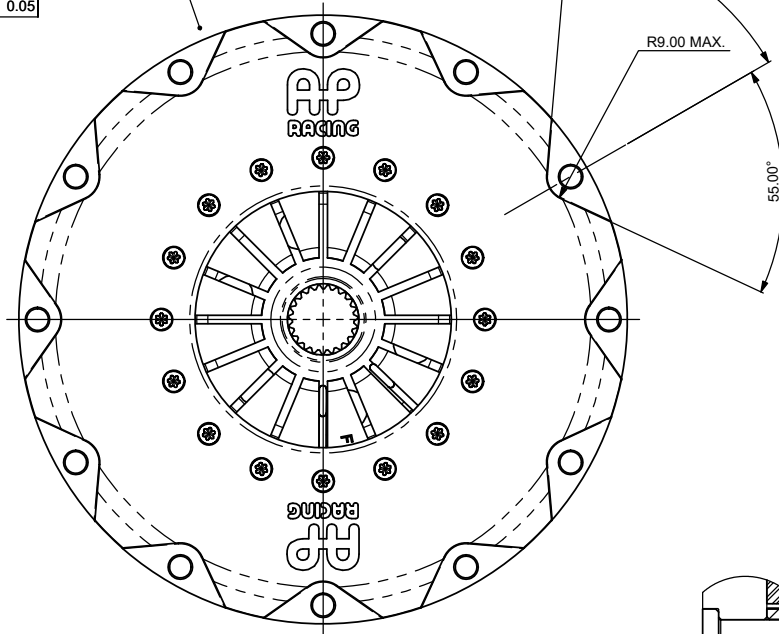

THIS 3 PLATE CARBON / CARBON CLUTCH IS INTERCHANGEABLE WITH CP3921-4GRY A Ø200mm SINGLE PLATE CERAMETALIC CLUTCH ASSEMBLY.

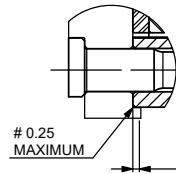

DETAIL B
SCALE 2 : 1

SET UP HEIGHT WORN (SEE CHART)
SET UP HEIGHT NEW (SEE CHART)

CARBON / CARBON STACK HEIGHT

RECOMMENDED CLUTCH MOUNTING :
M8 x 1.0 CP4702 FAMILY STUD AND K-LOCK NUT.
TIGHTENING TORQUE : 19 Nm (14 lb.ft)

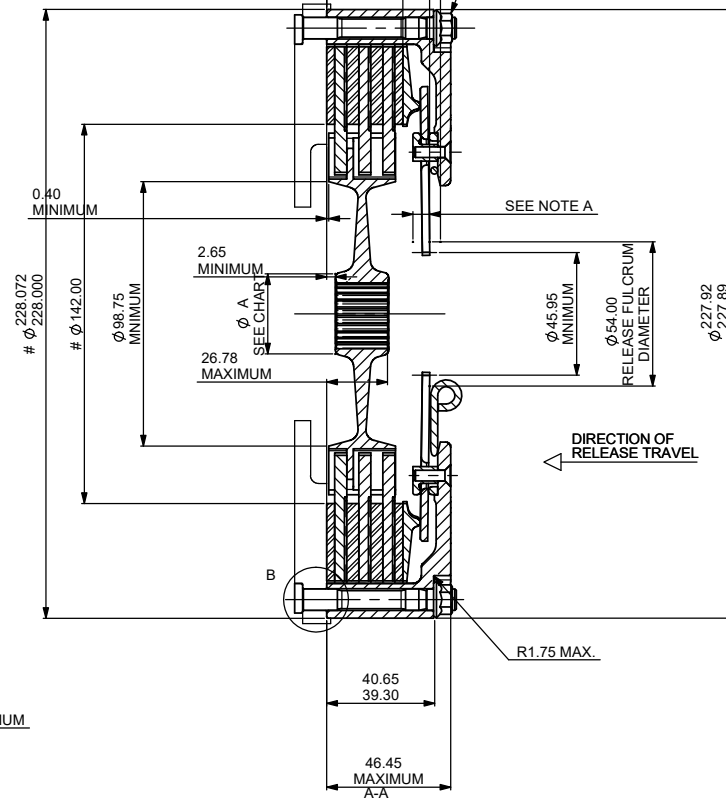

NOTE A :
RELEASE TRAVEL TO BE LIMITED TO 5.50mm MAXIMUM.

NOTE B :
INSTALLATION WIRE FOR USE WHEN INSTALLING CLUTCH TO ENSURE FLYWHEEL SIDE CARBON PLATE IS LOCATED ON THE COVER LUGS.

THIS WIRE MUST BE REMOVED BEFORE USE.

- FLYWHEEL DIMENSIONS.
ALTERNATIVE CLUTCH MOUNTING: CAP HEAD BOLT (C'BORED TREAD) TIGHTENING TORQUE 22.0 Nm (16 lb ft)

HUB DETAILS

HUB PART No.	SPLINE DETAIL	ØA' MAX
CP4203-102	1.00" x 23	30.25
CP4203-103	0.875" x 20	27.25
CP4203-104	29.0 x 10	34.25
CP4203-110	1 5/32" x 26	30.50

HUBS ARE AVAILABLE WITH OTHER SPLINE SIZES.

ASSEMBLY MASS AND INERTIA

ASSEMBLY MASS (kg)	ASSEMBLY INERTIA (kgm ²)	DRIVEN PLATES & HUB INERTIA (kgm ²)
3.48	0.02255	0.00472

BASED ON ASSEMBLY (HIGHEST MASS AND INERTIA IN THIS FAMILY), WITH A STEEL HUB. OTHER VALUES AVAILABLE UPON REQUEST.

Issue No.	Date & No.	Particulars	Zone	Initials
1	24/09/01 C1903	FIRST ISSUE	#	JG
2	21/02/07	INERTIA CORRECTION 0.02255 WAS 0.2266	#	JG
3	27/2/17 RAC22221	CL01-FN 'WEAR IN' CHANGED FROM 1.50 TO 1.00MM. CL01-FN 'SET UP HEIGHT NEW' CHANGED FROM 39.25 - 37.80 TO 39.46 - 37.56MM. CL01-FN 'SET UP HEIGHT WORN' CHANGED FROM 42.59 TO 41.77MM OL01-FN 'SET UP HEIGHT NEW' CHANGED FROM 39.05 - 37.60 TO 39.27 - 37.37MM. OL01-FN 'SET UP HEIGHT WORN' CHANGED FROM 42.39 TO 42.73. CH01-FN 'SET UP HEIGHT NEW' CHANGED FROM 39.83 - 38.06 TO 39.92 - 38.00MM. CH01-FN 'SET UP HEIGHT WORN' CHANGED FROM 43.14 TO 43.39MM. TH01-FN 'WEAR IN' CHANGED FROM 1.50 TO 1.00MM. TH01-FN 'SET UP HEIGHT NEW' CHANGED FROM 39.83 - 38.06 TO 40.17 - 37.81MM. TH01-FN 'SET UP HEIGHT WORN' CHANGE FROM 47.65 TO 43.64MM.	#	WJB
4	17/08/21 CS375_01	'MAX PEAK NEW' WAS 'AT TRAVEL' 'MAX PEAK WORN' AND 'MAX PEAK NEW' VALUES CORRECTED TO CONFORM WITH MIS1000 'N' WAS 'daN'	C1	JRV

SCALE 1:1 SHEET 1 OF 1

DRAWN JEREMY GOVAN

APPROVED

DERIVED FROM #

TITLE

Ø200mm CARBON / CARBON
3 PLATE CLUTCH INSTALLATION

DRG NO. CP7213CD

CLUTCH PART No. SUFFIX	CP7213-CL01-FN	CP7213-OL01-FN	CP7213-CH01-FN	CP7213-TH01-FN
MAXIMUM DYNAMIC TORQUE CAPACITY Nm (lb.ft)	708 (522)	466 (344)	1050 (783)	1050 (783)
MAXIMUM WEAR IN #	1.00	1.50	1.00	1.00
RELEASE LOAD (MAX PEAK WORN) N	4400	3300	4400	5100
RELEASE LOAD (MAX PEAK NEW) N	3500	2400	3500	4000
SET UP HEIGHT NEW	39.44 37.56	39.27 37.37	39.92 38.00	40.17 37.81
SET UP HEIGHT WORN	41.77	42.73	43.39	43.64

THIS CLUTCH HAS BEEN DESIGNED FOR THE WEAR IN INDICATED, WHICH MUST BE COMPENSATED FOR BY USING PRESSURE PLATES FROM EITHER OF THE KITS DETAILED BELOW. MAXIMUM CARBON STACK WEAR IS 6.00mm
AXIAL HUB FLOAT MUST BE MAINTAINED

STANDARD	CP4202-9S (1.50 - 4.50, 1.50 STEPS)	CP4202-9S (1.50 - 4.50, 1.50 STEPS)	CP4212-4S (1.00 TO 5.00, 1.00 STEPS)	CP4212-6S (0.50 TO 4.50, 0.50 STEPS)
INTERMEDIATE	CP4202-10S (0.50 - 4.00, 0.50 STEPS)	CP4202-10S (0.50 - 4.00, 0.50 STEPS)	CP4212-5S (0.50 - 4.50, 1.00 STEPS)	CP4212-8S (0.25 TO 3.25, 0.50 STEPS)