

CP6265-105 CARBON DUCT KIT

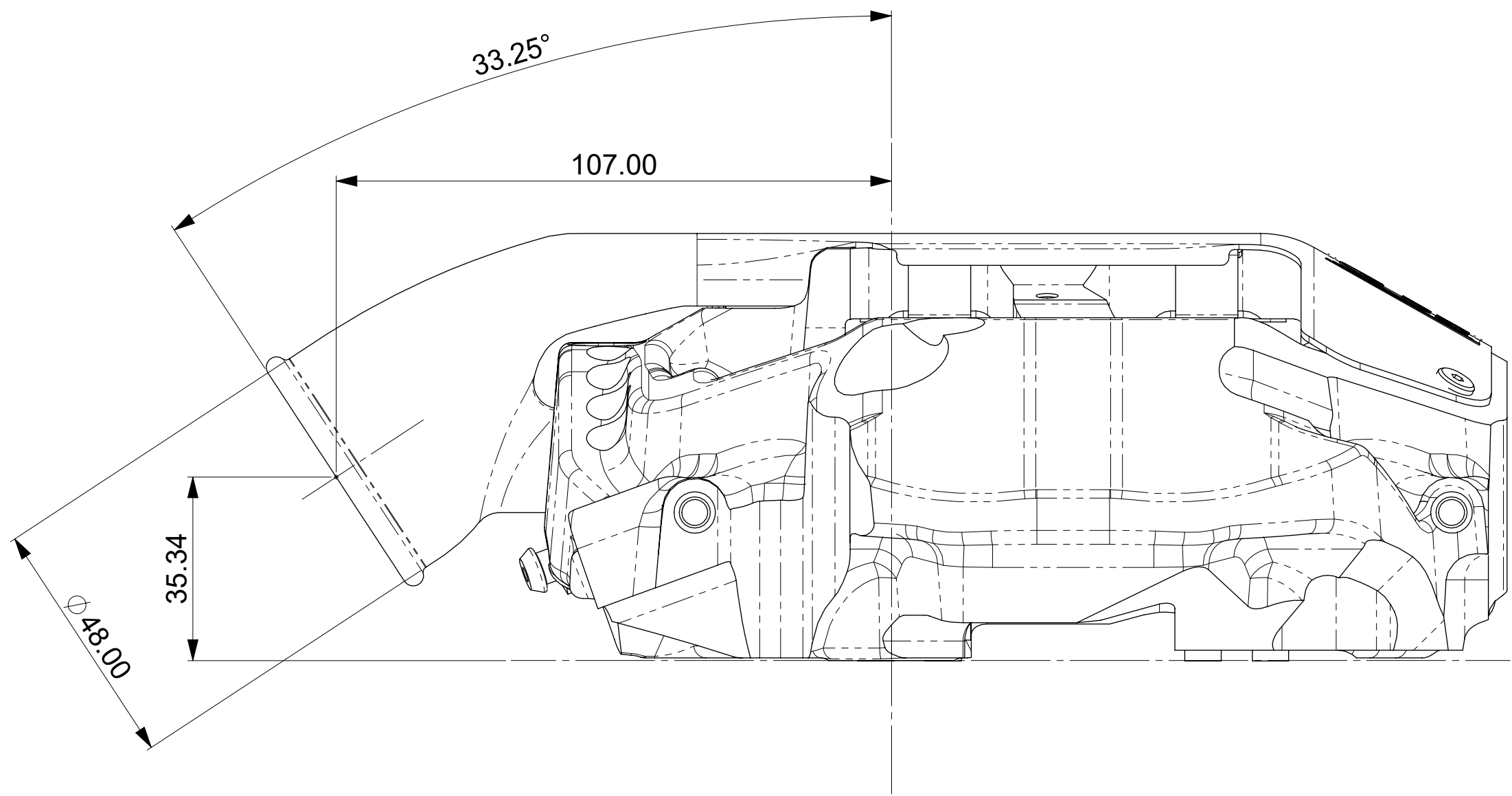

RECESS IN DUCT CAN BE COVERED WITH
DUCT TAPE OR SIMILAR ONCE THE
SCREW HAS BEEN FITTED TO CREATE A
SMOOTH SURFACE TO FACILITATE AIR
FLOW.

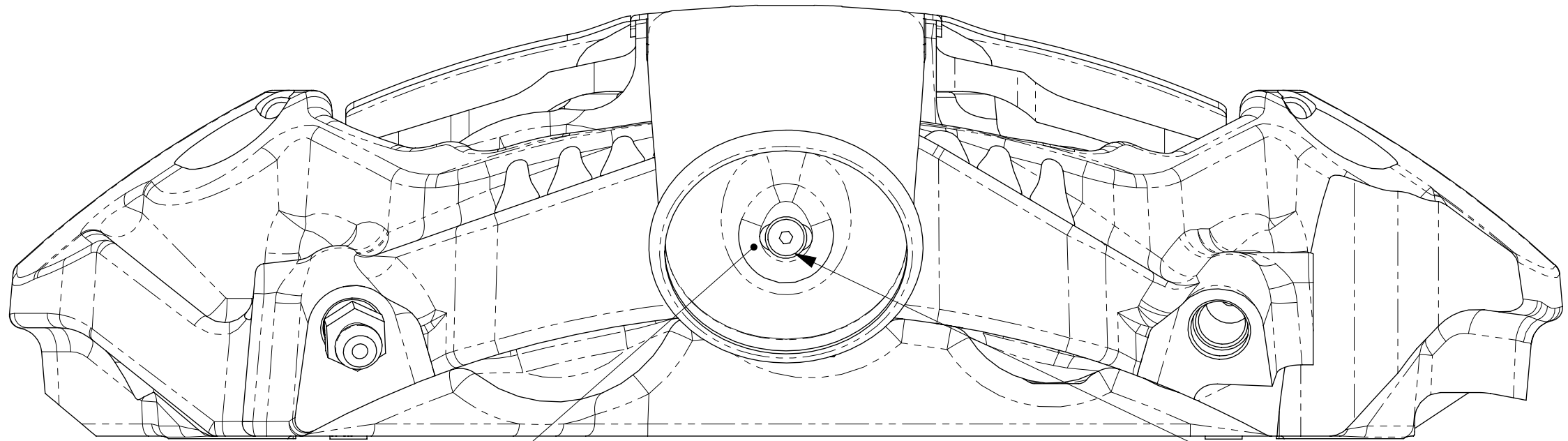

3 OFF M4x6.00 LOW PROFILE
SCREWS TO RETAIN CARBON DUCT.

3x CP6078-106 SCREWS ARE
INCLUDED IN CP6265-105 CARBON
DUCT KIT.

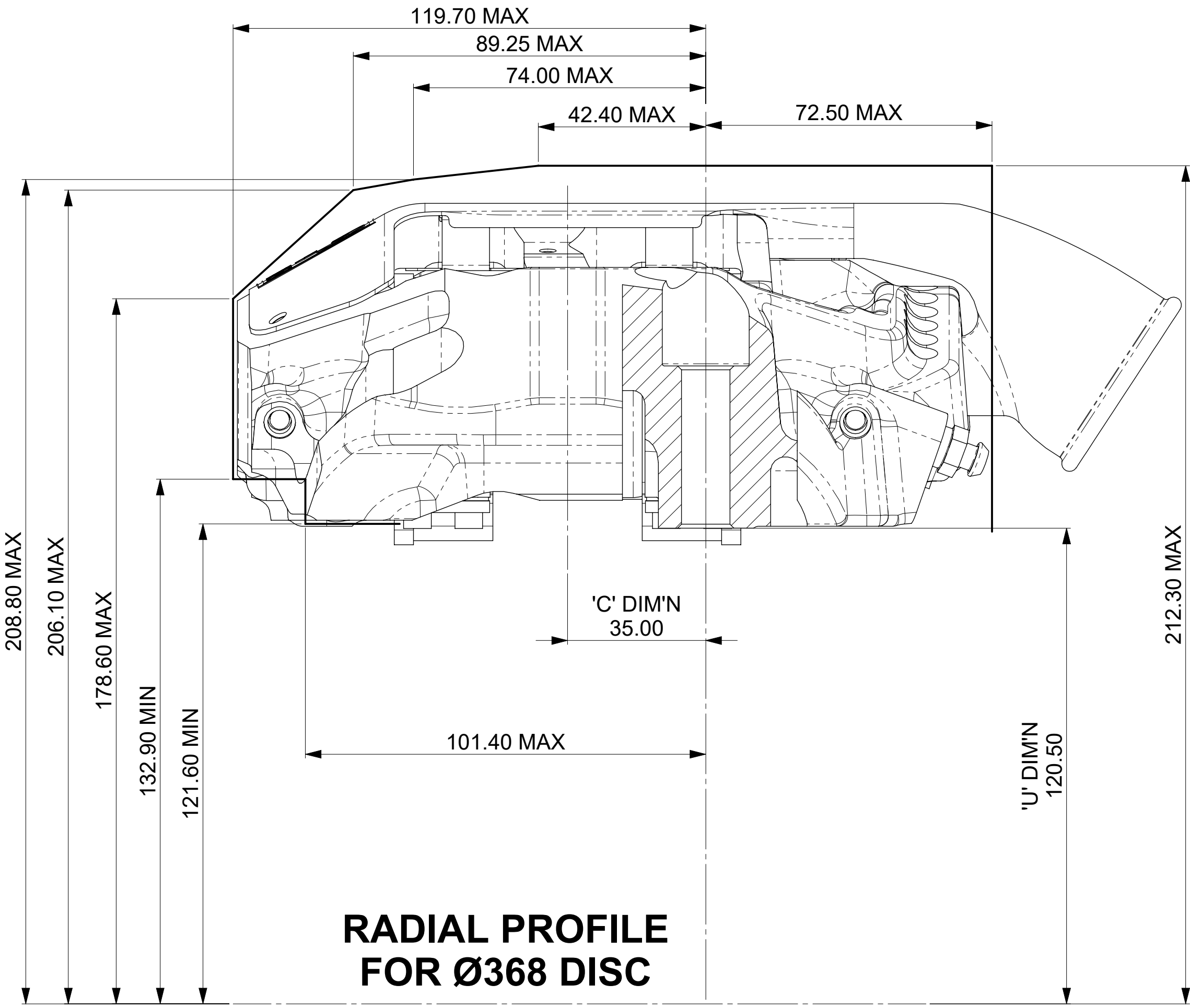
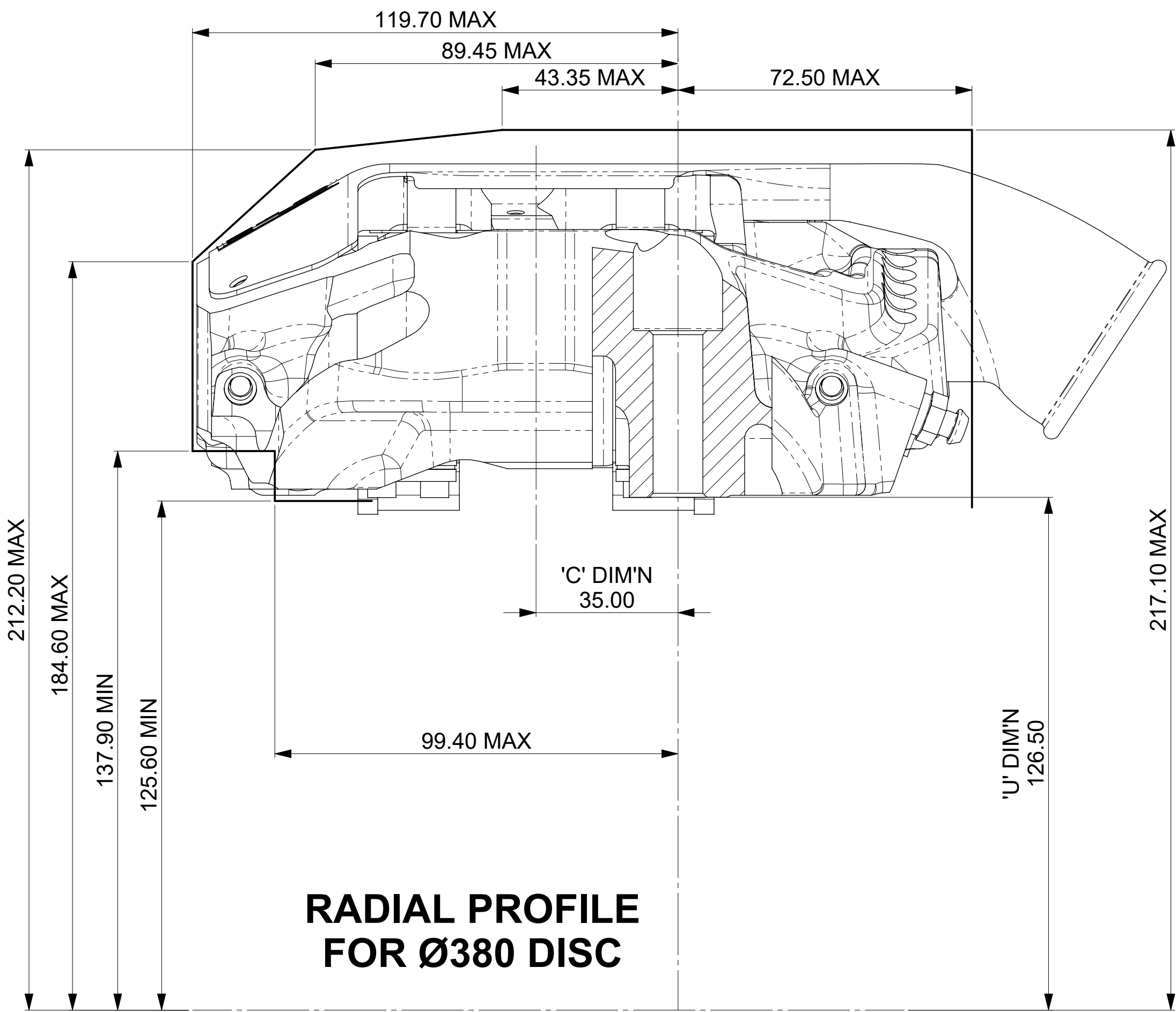
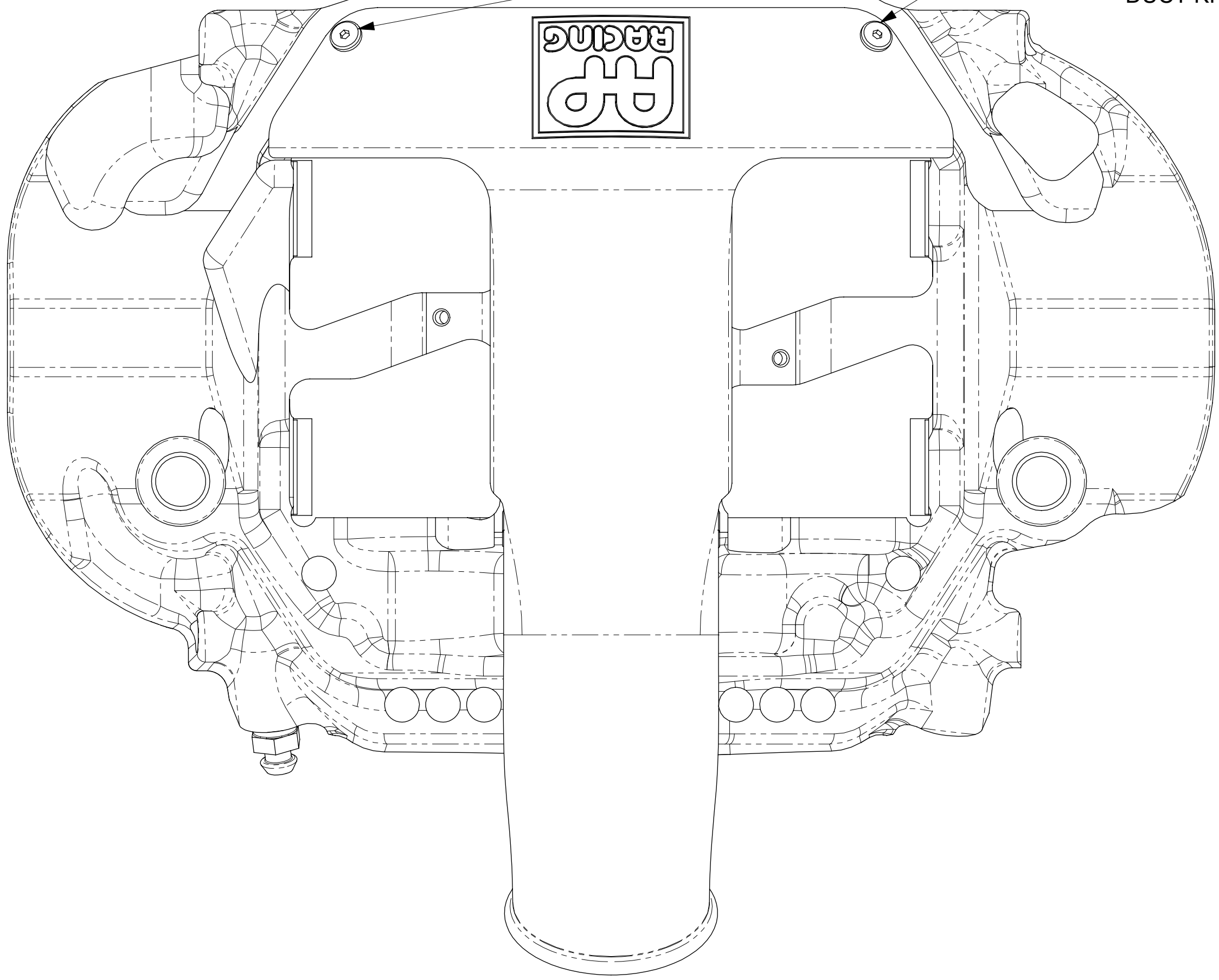

Alterations		Zone	Initials
Issue No.	Date & No.	Particulars	
-	-	SEE SHEET 1 FOR ISSUE INFORMATION.	-
SCALE 1:1		SHEET 2 OF 3	
DRAWN		T HARGRAVE-SMITH	
APPROVED			
DERIVED FROM		CP6667-13CD	
TITLE		6 PISTON CALIPER MONOBLOC	
DRG NO.		CP6667-20CD	

