

B1 INSTALLATION DRAWING

IF THIS DOCUMENT IS PRINTED IN HARDCOPY, IT IS FOR INFORMATION USE ONLY AND THEREFORE IS NOT SUBJECT TO UPDATING CONTROLS. ALWAYS REFER TO SOLIDWORKS VIEWER FOR LATEST ISSUE



THIS DRAWING IS CONFIDENTIAL AND IS SUPPLIED ON THE EXPRESS CONDITION THAT IT SHALL NOT BE LOANED OR COPIED OR DISCLOSED TO ANY OTHER PERSON OR USED FOR ANY OTHER PURPOSE WITHOUT THE WRITTEN CONSENT OF AP RACING LTD.

AP Racing
 Coventry
 CV3 4LB
 Tel: +44 024 7663 9595
 Fax: +44 024 7663 9559
 e-mail: sales@apracing.co.uk
 Web site: [HTTP://www.apracing.com](http://www.apracing.com)

© AP Racing Ltd. 2026

Issue No.	Date & No.	Particulars	Zone	Initials
01	13/08/2021 B8269	FIRST ISSUE	#	JDD
02	20/10/2021 B8269	LVDI CP4969-519 ADDED TO OPTIONAL EXTRAS	#	JDD
03	10/11/2021 B8269_17	PAD PART NUMBER CHANGED TO CP4970-67, WAS CP4970-150	#	JDD
04	16/12/2021 B8269_23	EFFECTIVE RADIUS CORRECTED TO 151.0, WAS 141.0	#	JDD
05	10/03/2022 B8269_24	SHEET 3 SPARES KIT PART NUMBERS ADDED	#	JDD
06	11/08/2022 B8269_30	SHEET 3 AKB SPRING KITS PART NUMBERS CORRECTED	#	JDD
07	30/03/26 B8269_34	SHEET 3 CORRECTED PART NUMBER - WAS CP6178-106 NOW CP6187-106 CORRECTED PART DESCRIPTION - WAS 'BLEED SCREW' NOW 'INLET FITTING 3/8" x 24 UNF' CORRECTED PART DESCRIPTION - WAS 'DRY BLEED SCREW KIT' NOW 'DRY BLEED FITTING' ADDED COPPER WASHER (KL44517) TO PARTS TABLE	N12 J10 K10 H10	JSD

GENERAL DESCRIPTION
 6 PISTON DIFFERENTIAL BORE CALIPER TO SUIT UP TO Ø355x35mm CARBON DISC WITH A FIXED BRIDGE DESIGN.

TYPICAL APPLICATION - LMDh / GT

CALIPER SPECIFICATION	
BORE SIZE	BDE (26.00 x 28.58 x 31.75) (1.02" x 1.125" x 1.25")
PISTON AREA (TOTAL)	39.3cm ²
DISC DIAMETER MAX	355.0mm
DISC THICKNESS (NEW)	32.00-35.00mm
PAD PART NUMBER	CP4970-67 (23.50mm THICK)
PAD THICKNESS (NEW)	25.00-23.50mm
STACK WIDTH NEW	82.00mm
STACK WIDTH WORN	49.00mm
MAX WEAR PER SIDE	16.50mm
HYDRAULIC FEED	M10x1.0 15.00 THREAD DEPTH
DUCTING MOUNTS	M4x0.70 5.0mm MIN THREAD DEPTH
SCRAPER MOUNTS	NONE
TEMPERATURE SENSOR MOUNT	M4x0.70 5.0mm MIN THREAD DEPTH
DRY WEIGHT (WITHOUT PADS)	2.13kg (EST.)
EFFECTIVE RADIUS (ON Ø355mm DISC)	151.0mm
'PL' DIMENSION (TOP OF PAD FRICTION MATERIAL TO CALIPER MOUNTING FACE)	63.50mm
'C' DIMENSION (CALIPER OFFSET)	42.00mm
'U' DIMENSION (UPRIGHT MOUNTING)	114.0mm U = (DISC Ø / 2) - PL
TIGHTENING TORQUES	BLEED SCREW: SEE SHEET 3 PAD LEDGE SCREWS: 4Nm TYPICAL M12 MOUNTING BOLT: 65Nm (GUIDANCE ONLY)

CALIPER POSITIONING	
RHT	RIGHT HAND TRAILING (BEHIND AXLE)
LHT	LEFT HAND TRAILING (BEHIND AXLE)

PART NUMBERING CONVENTION	
PART NUMBER	DESCRIPTION
CP6187-2SOM	RIGHT HAND TRAILING - TITANIUM PISTONS
CP6187-3SOM	LEFT HAND TRAILING - TITANIUM PISTONS

INSTALLATION INFORMATION
 THE CALIPER IS DESIGNED SO THAT THE DISC WILL BE MOUNTED CENTRALLY WITHIN A TOLERANCE OF ±0.50mm.
 THE CALIPER IS TO BE MOUNTED IN EITHER A TRAILING POSITION 0.0°/-35.0° FROM VERTICAL, OR A LEADING POSITION ±15° FROM VERTICAL.
 THE DIAMETRICAL CLEARANCE BETWEEN THE DISC OUTSIDE DIAMETER AND THE PATHWAY SHOULD BE 2.50mm NOMINALLY.

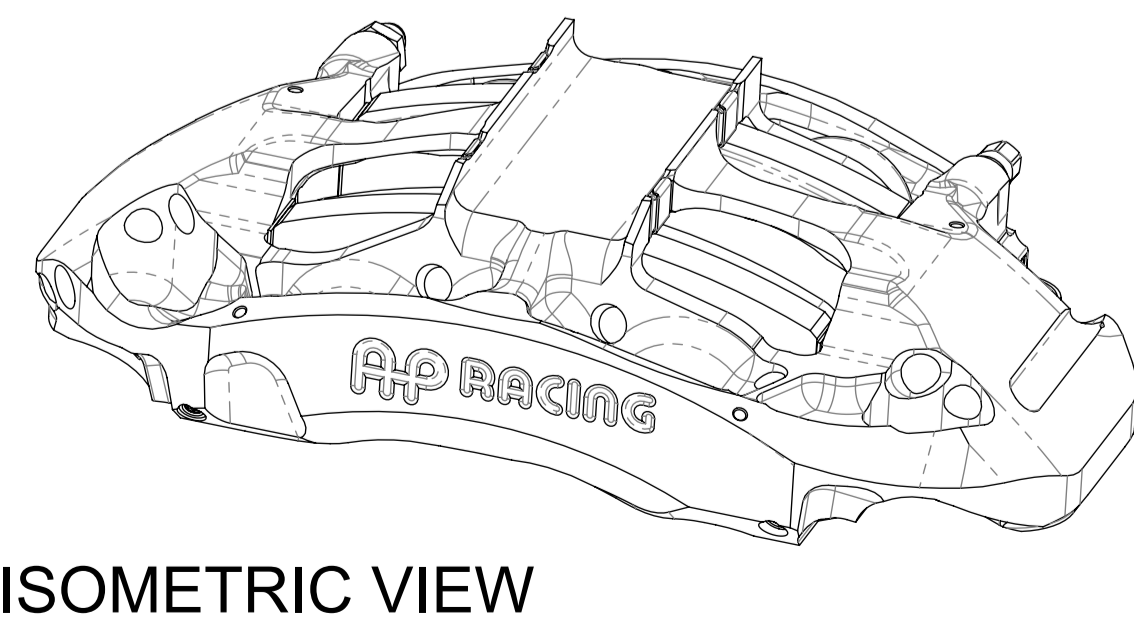
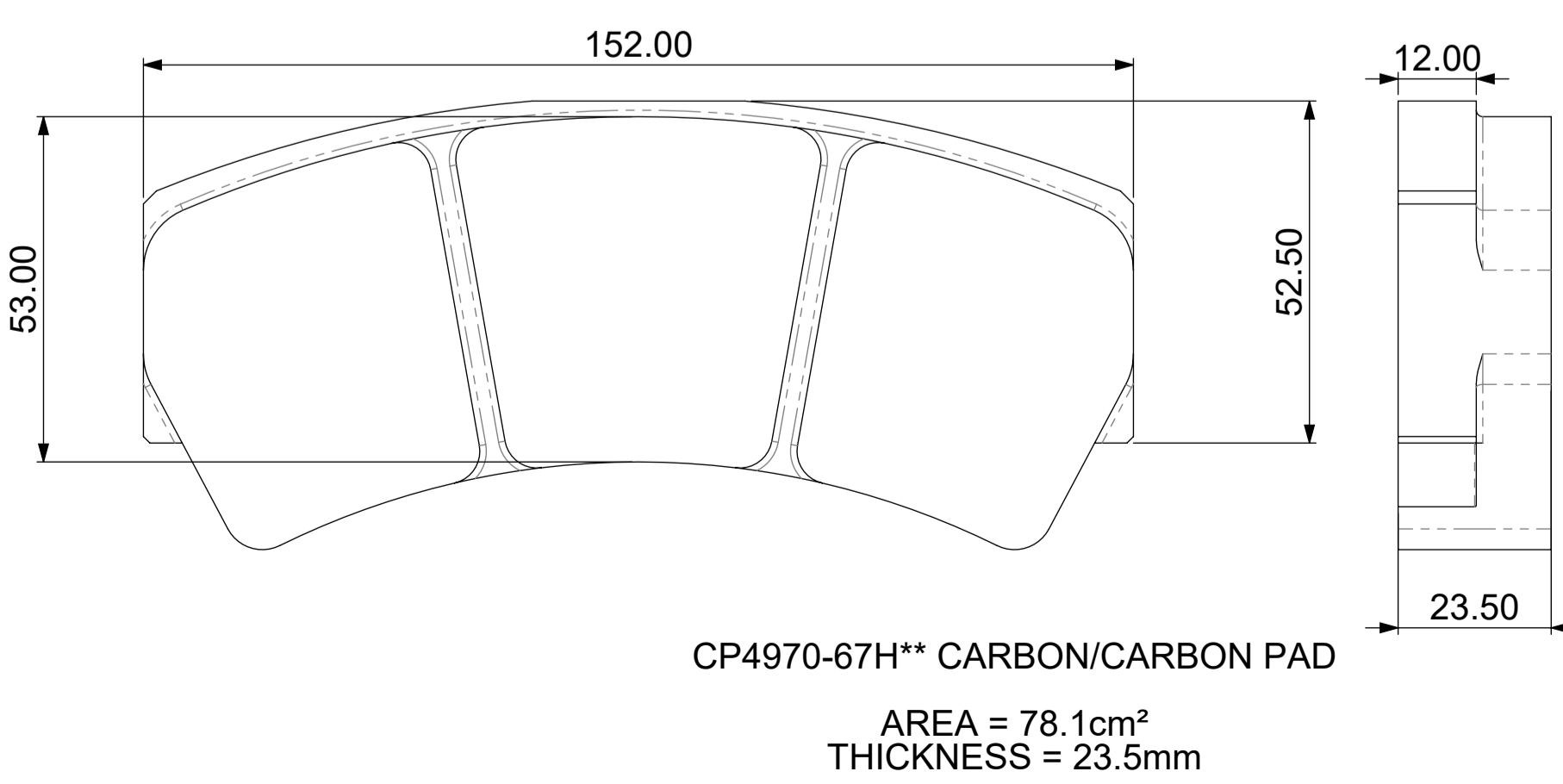
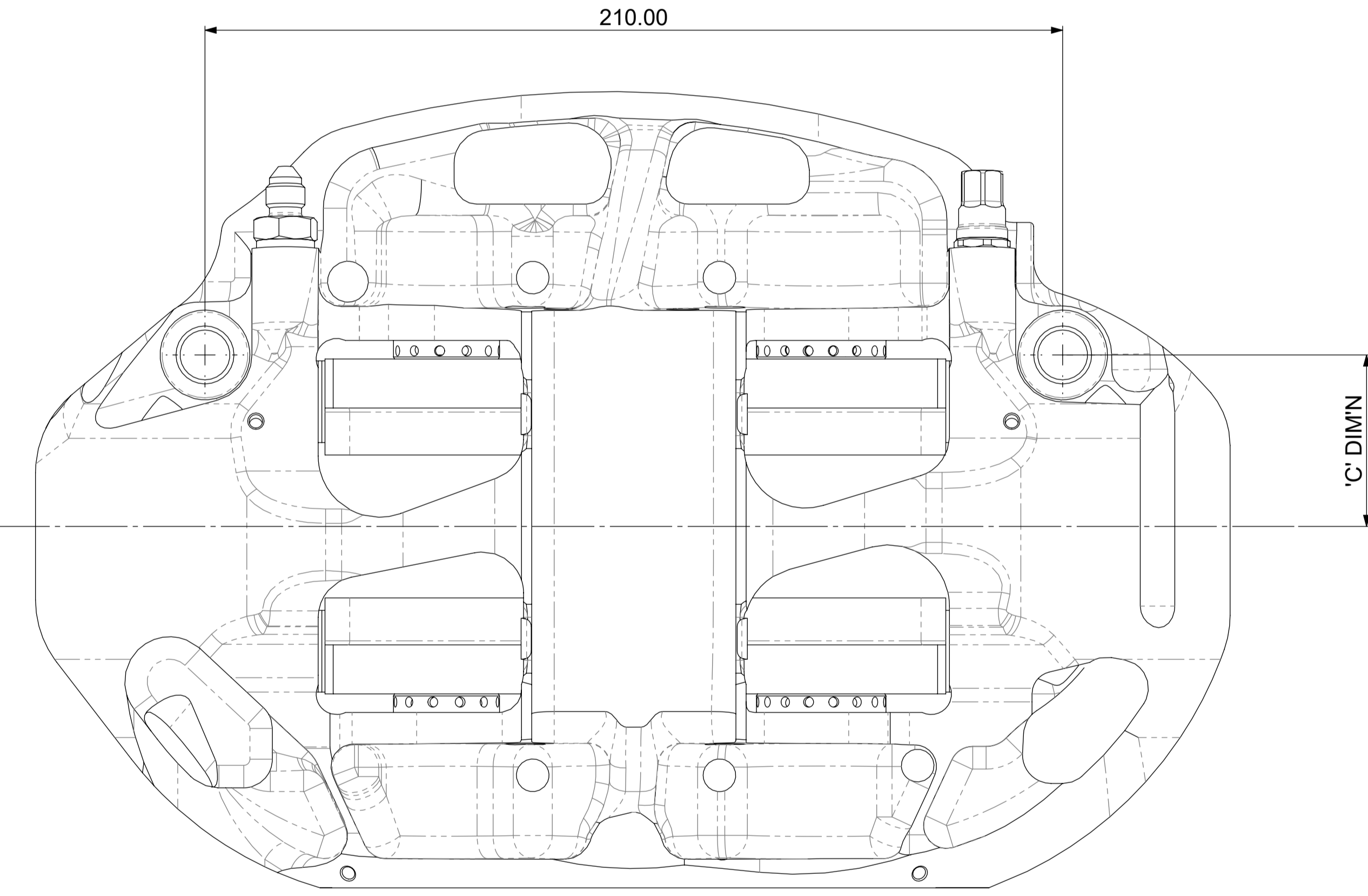
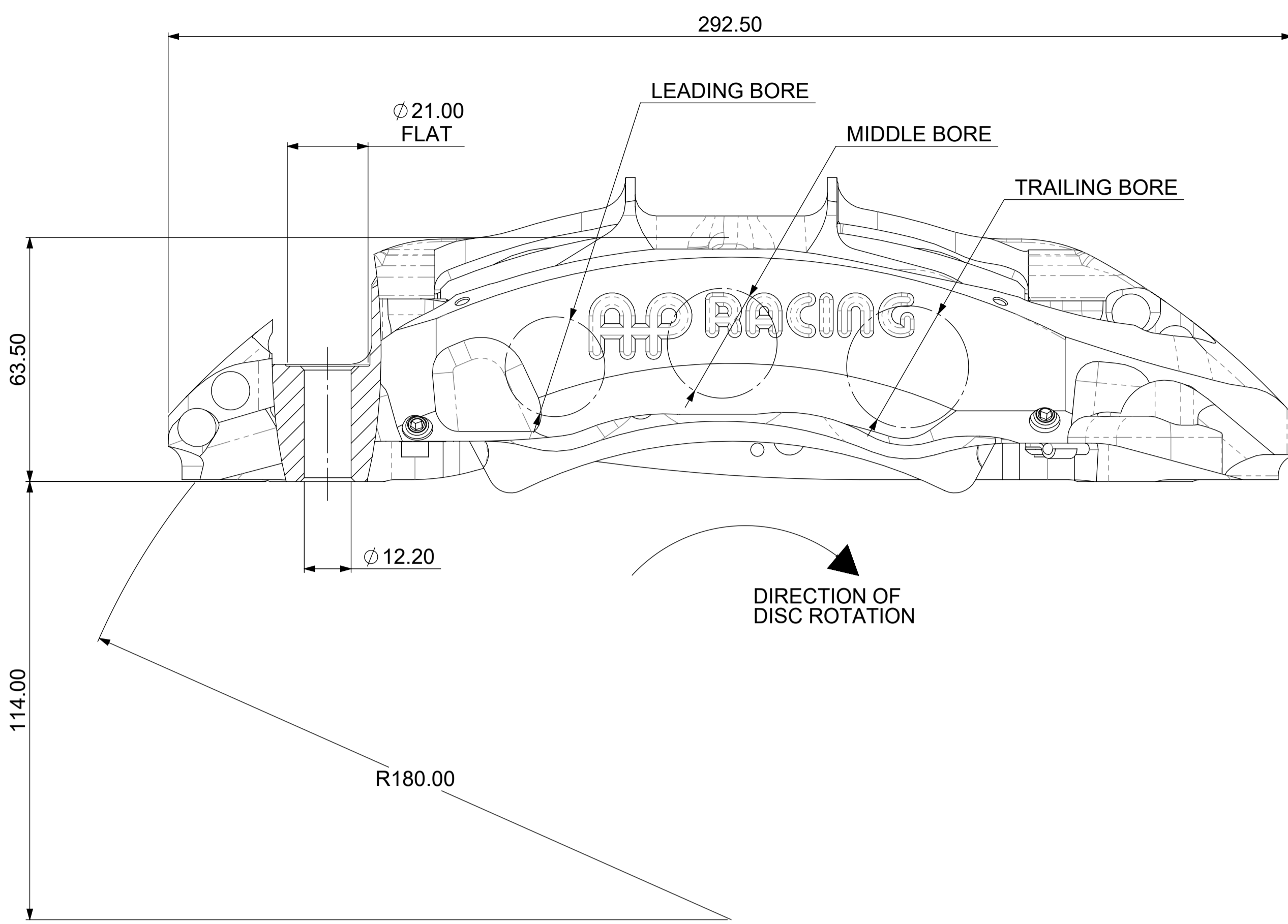

OPTIMUM BLEED POSITIONING
 FOR OPTIMUM BLEED, THE CALIPER SHOULD BE INSTALLED IN A POSITION BETWEEN THE ANGLES SHOWN

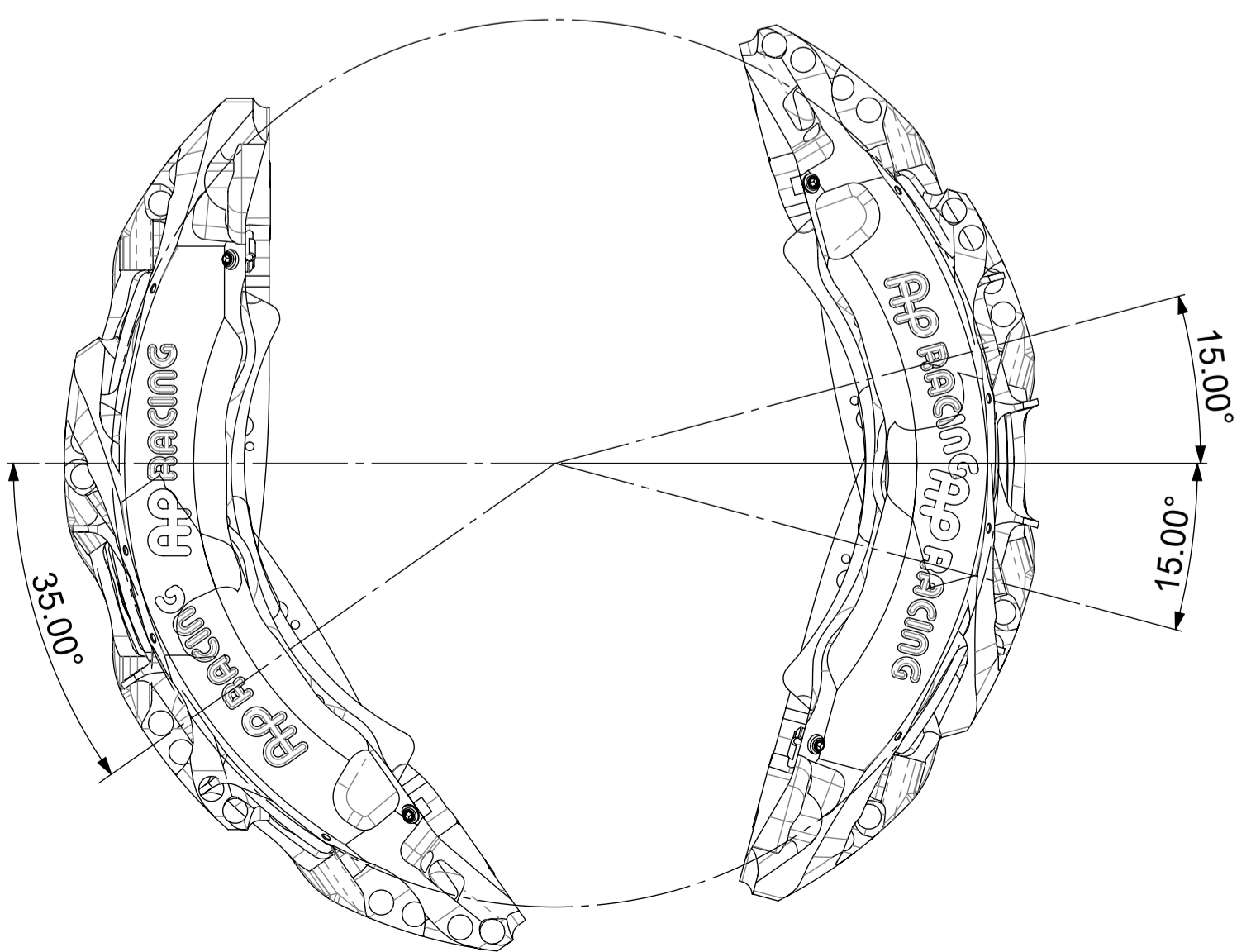

SCALE 1:1 SHEET 1 OF 3

DRAWN jdavies

APPROVED

DERIVED FROM

TITLE
 6 PISTON (BDE) CALIPER
 Ø355x35.0 DISC & 53.0 PAD

DRG NO. CP6187-1cd

B1 INSTALLATION DRAWING

IF THIS DOCUMENT IS PRINTED IN HARD COPY, IT IS FOR INFORMATION USE ONLY AND THEREFORE IS NOT SUBJECT TO UPDATING CONTROLS. ALWAYS REFER TO SOLIDWORKS VIEWER FOR LATEST ISSUE



THIS DRAWING IS CONFIDENTIAL AND IS SUPPLIED ON THE EXPRESS CONDITION THAT IT SHALL NOT BE LOANED OR COPIED OR DISCLOSED TO ANY OTHER PERSON OR USED FOR ANY OTHER PURPOSE WITHOUT THE WRITTEN CONSENT OF AP RACING LTD.

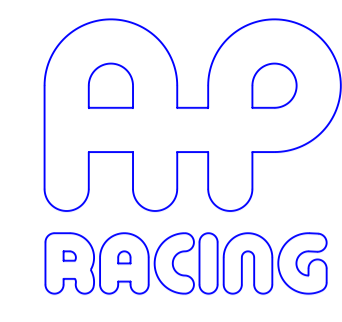

AP Racing
Wheler Road
Coventry
CV3 4LB
Tel: +44 024 7663 9595
Fax: +44 024 7663 9559
e-mail: sales@apracing.co.uk
Web site: [HTTP://www.apracing.com](http://www.apracing.com)

© AP Racing Ltd. 2026

Issue No.	Date & No.	Particulars	Zone	Initials
-	-	SEE SHEET 1 FOR ISSUE INFORMATION.	-	-

DUCT MOUNTING POINTS

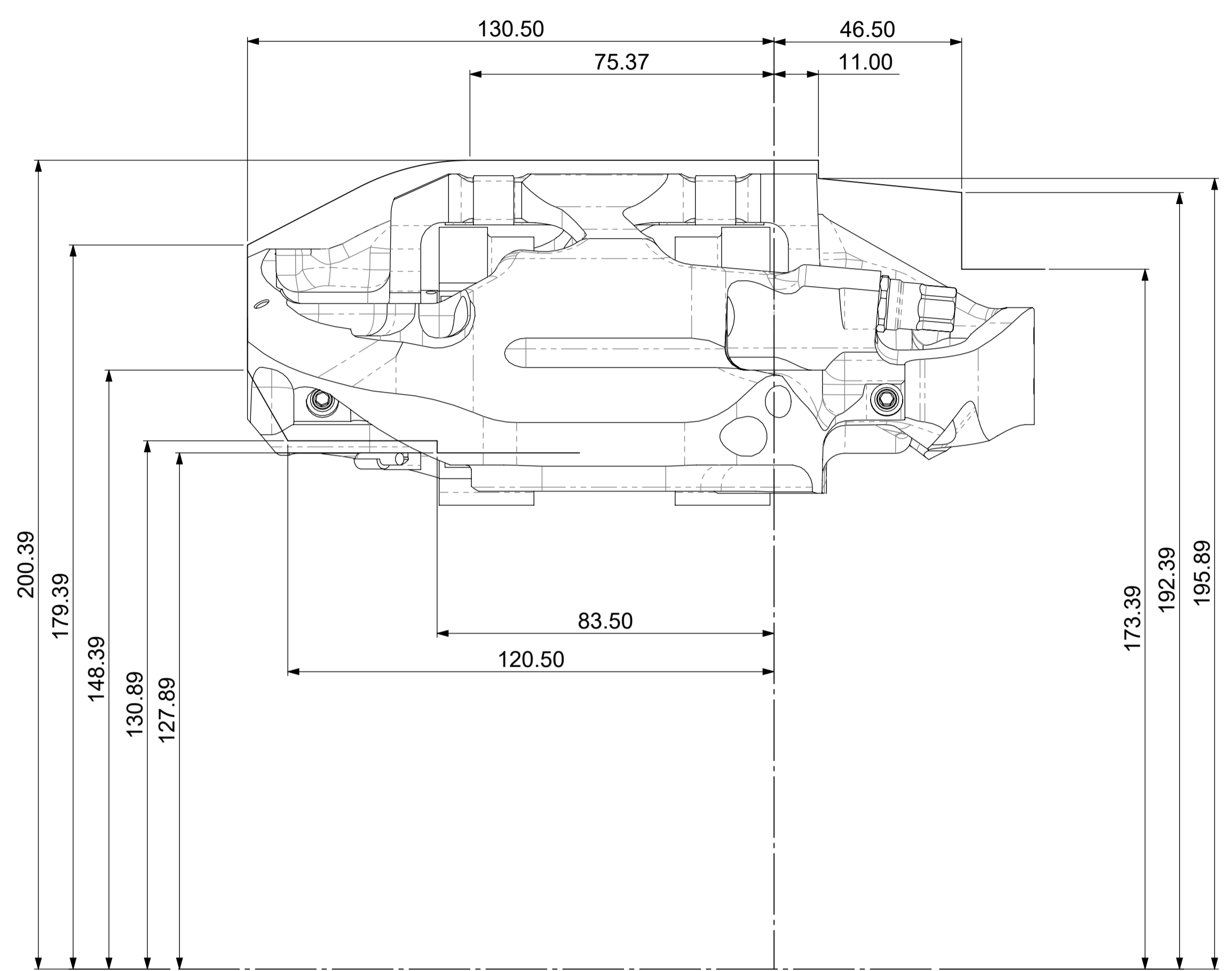

RADIAL PROFILE FOR Ø355.0 DISC

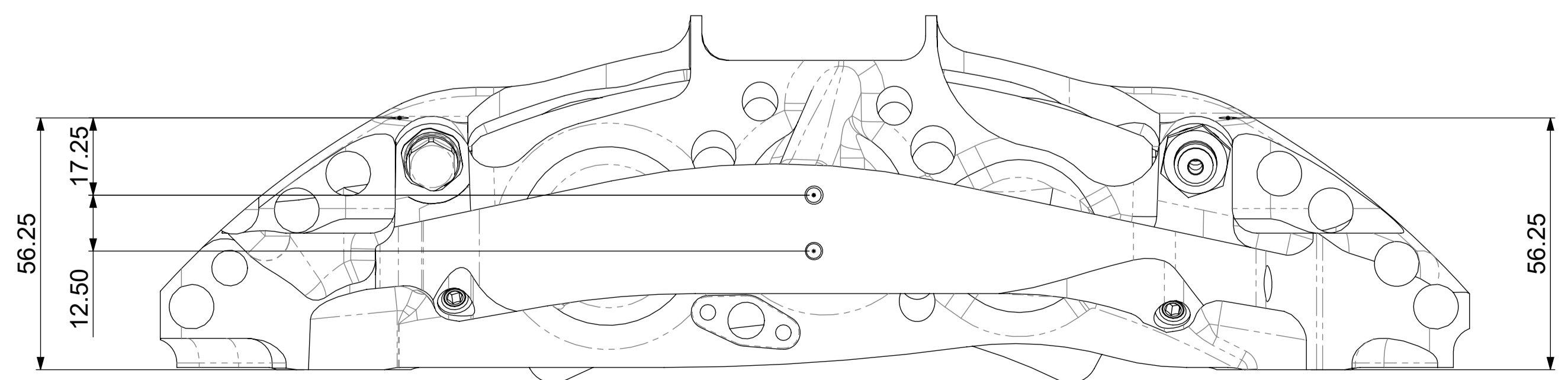
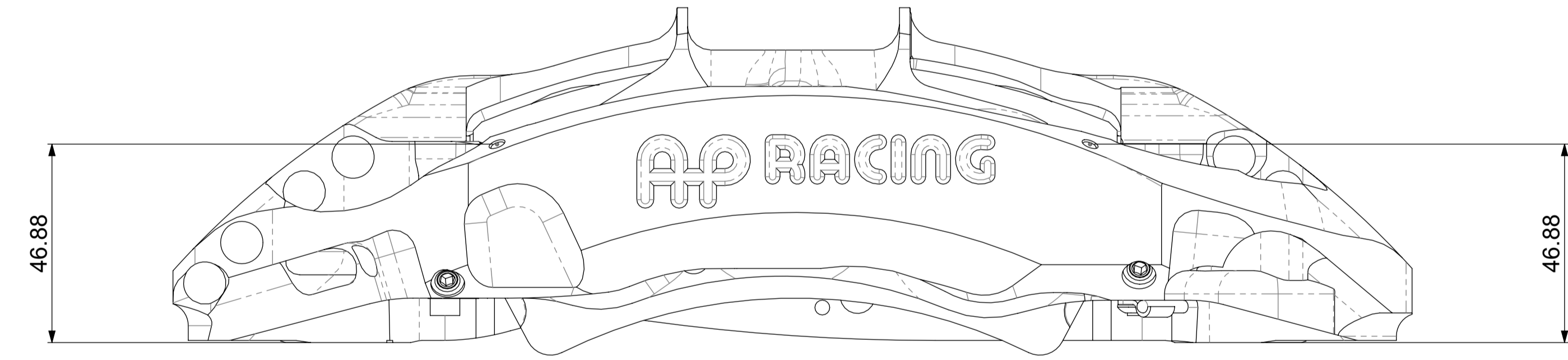
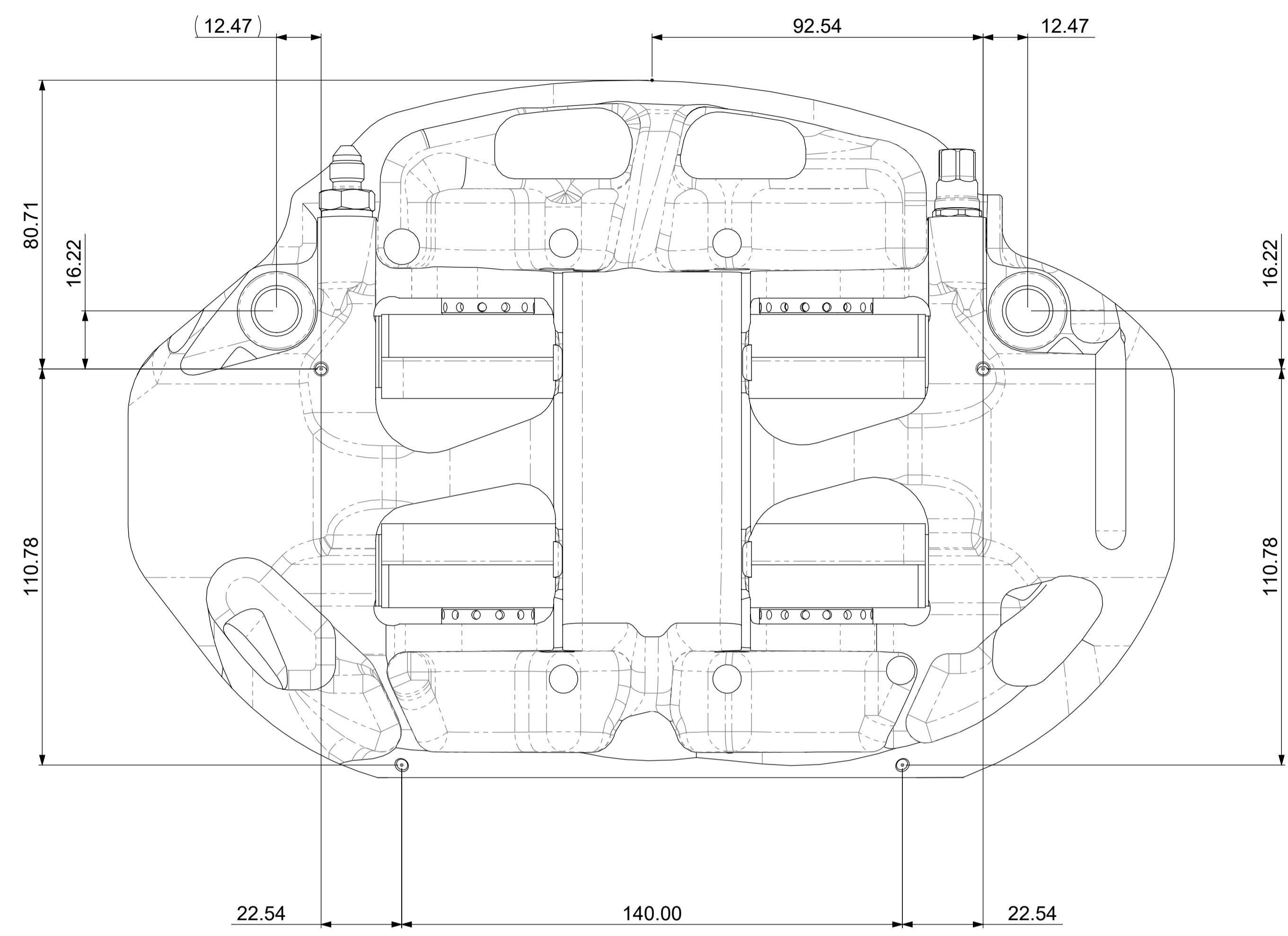

SCALE 1:1 SHEET 2 OF 3

DRAWN jdavies

APPROVED

DERIVED FROM

TITLE
6 PISTON (BDE) CALIPER
Ø355x35.0 DISC & 53.0 PAD

DRG NO. CP6187-1cd

B1 INSTALLATION DRAWING

IF THIS DOCUMENT IS PRINTED IN HARDCOPY, IT IS FOR INFORMATION USE ONLY AND THEREFORE IS NOT SUBJECT TO UPDATING CONTROLS. ALWAYS REFER TO SOLIDWORKS VIEWER FOR LATEST ISSUE



THIS DRAWING IS CONFIDENTIAL AND IS SUPPLIED ON THE EXPRESS CONDITION THAT IT SHALL NOT BE LOANED OR COPIED OR DISCLOSED TO ANY OTHER PERSON OR USED FOR ANY OTHER PURPOSE WITHOUT THE WRITTEN CONSENT OF AP RACING LTD.

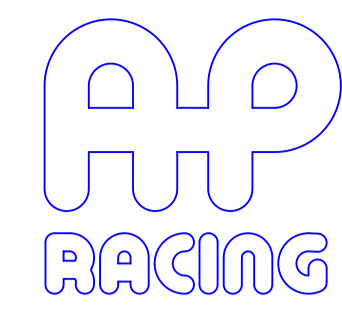

AP Racing
Wheler Road
Coventry
CV3 4LB
Tel: +44 024 7663 9595
Fax: +44 024 7663 9559
e-mail: sales@apracings.co.uk
Web site: HTTP://www.apracings.com

CP6187-2 / 3S0L SPARES

REF	DESCRIPTION	PART NUMBER	QTY PER ASSEMBLY	FITTING INSTRUCTIONS
1	Ø26.00 [1.02"] TIT PISTON (B BORE)	CP6187-104	2	-
2	Ø28.58 [1.125"] TIT PISTON (D BORE)	CP6187-105	1	-
3	Ø28.58 [1.125"] TIT LVDT PISTON (D BORE)	CP4969-521	1	-
4	Ø31.75 [1.25"] TIT PISTON (E BORE)	CP6187-106	2	-
5	SEAL KIT (6 SEALS)	CP8518-BDE	1	REFER TO PUBLICATION REF P14.290 & P14.220
6	LID WEAR PLATE	CP6187-107	1	-
7	PAD ABUTMENT PLATE	CP6187-108	4	-
8	PAD SUPPORT	CP6187-109	4	-
9	M4x0.7 SOCKET HEAD CAP SCREW	CP3215-115	8	APPLY 1-2mm DROP OF LOCTITE 270 TO THE 2nd FROM LAST THREAD WHEN FITTING TIGHENING TORQUE - 4.0Nm
10	DRY BLEED FITTING	CP6300-21 (SEE CP6300-13CD)	1	APPLY A SMALL AMOUNT OF LOCTITE 270 TO THE THREADS BEFORE FITTING VALVE TIGHENING TORQUE - 13Nm CAP TIGHENING TORQUE - 4.0Nm
11	INLET FITTING 3/8" x 24 UNF	CP6160-107	1	APPLY A SMALL AMOUNT OF LOCTITE 270 TO THE THREADS BEFORE FITTING TIGHENING TORQUE - 17Nm
12	KL44517	COPPER WASHER	1	-
OPTIONAL EXTRAS				
13	LVDT KIT	CP4969-519	1	REQUIRES M3x0.5 BUTTON HEAD SCREW, MIN LENGTH 12.00mm
14	THERMOSENSOR KIT	SEE CP6282-1cd	2	-
-	AKB SPRING KIT, 4LB	CP6518-4LBSSS	1	-
-	AKB SPRING KIT, 7LB	CP6518-7LBSSS	1	-
-	AKB SPRING KIT, 9LB	CP6518-9LBSSS	1	-
-	AKB SPRING KIT, 12LB	CP6518-12LBSSS	1	-
SPARES KITS				
-	PISTON KIT	CP6187-50	1	-
-	WEAR PLATE KIT	CP6187-51	1	APPLY A SMALL AMOUNT OF RED RTV BEHIND THE WEAR PLATES DURING ASSEMBLY

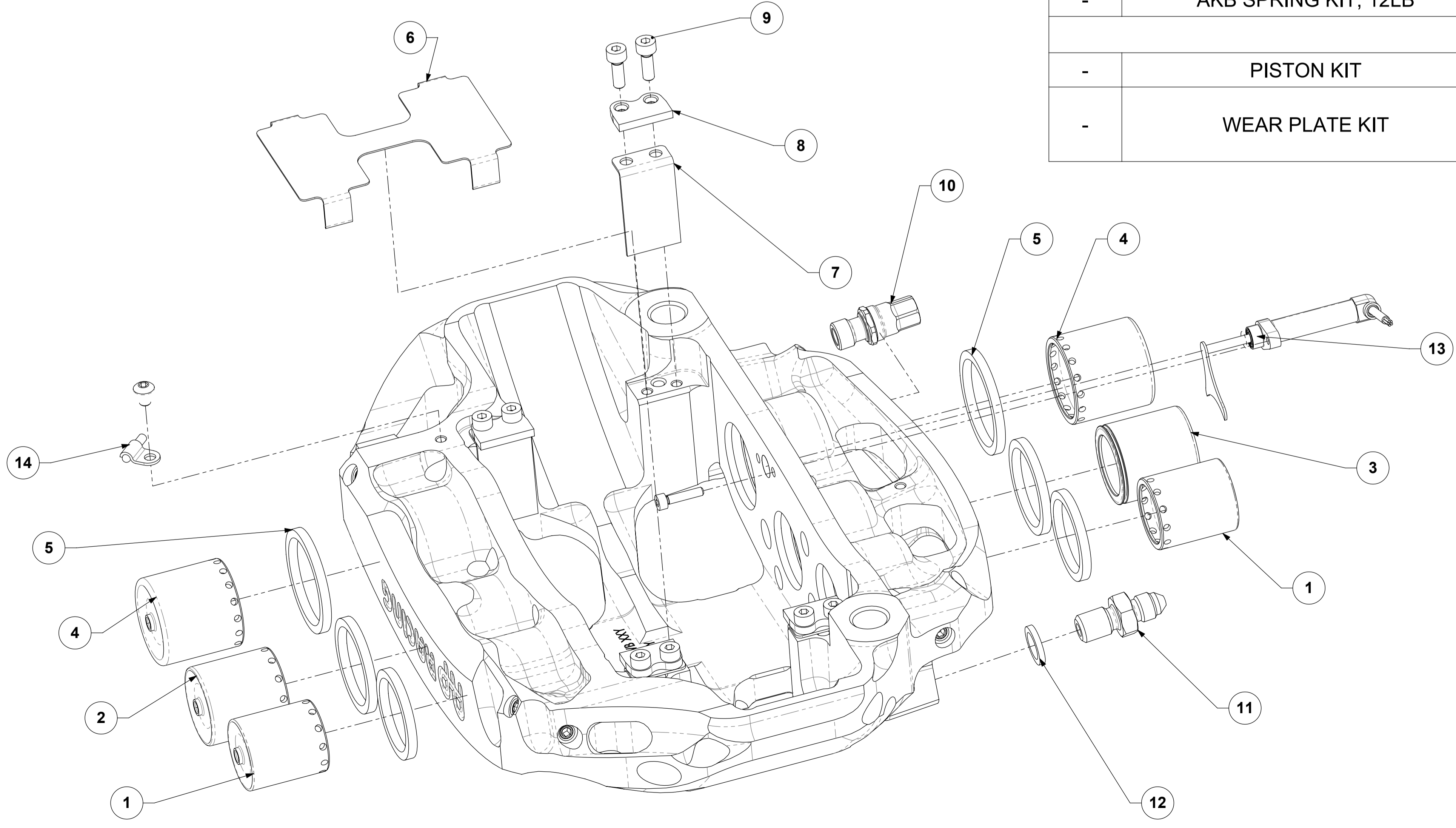

Issue No.	Date & No.	Alterations	Zone	Initials
-	-	SEE SHEET 1 FOR ISSUE INFORMATION.	-	-

SCALE 1:1 SHEET 3 OF 3

DRAWN jdavies

APPROVED

DERIVED FROM

TITLE
6 PISTON (BDE) CALIPER
Ø355x35.0 DISC & 53.0 PAD

DRG NO. CP6187-1cd