

A1 INSTALLATION DRAWING

IF THIS DOCUMENT IS PRINTED IN HARDCOPY, IT IS FOR INFORMATION USE ONLY AND THEREFORE IS NOT SUBJECT TO UPDATING CONTROLS. ALWAYS REFER TO SOLIDWORKS VIEWER FOR LATEST ISSUE



THIS DRAWING IS CONFIDENTIAL AND IS SUPPLIED ON THE EXPRESS CONDITION THAT IT SHALL NOT BE LOANED OR COPIED OR DISCLOSED TO ANY OTHER PERSON OR USED FOR ANY OTHER PURPOSE WITHOUT THE WRITTEN CONSENT OF AP RACING LTD.



AP Racing
Wheler Road
Coventry
CV3 4LB

Tel: +44 (0) 24 7663 9595
Fax: +44 (0) 24 7663 9559
e-mail: engineering@apracings.co.uk
Web site: <http://www.apracings.com>

© AP Racing Ltd. 2005

Issue No.	Alterations			Zone	Initials
	Date & No.	Particulars			
1	23/09/04 B4080	FIRST ISSUE			BAT
2	20/11/08 B4460: ID121	0.20/0.00 STEP OUT ADDED Ø189.7 ADDED 9.50 WAS 9.60		J4 F5 K3	BRA

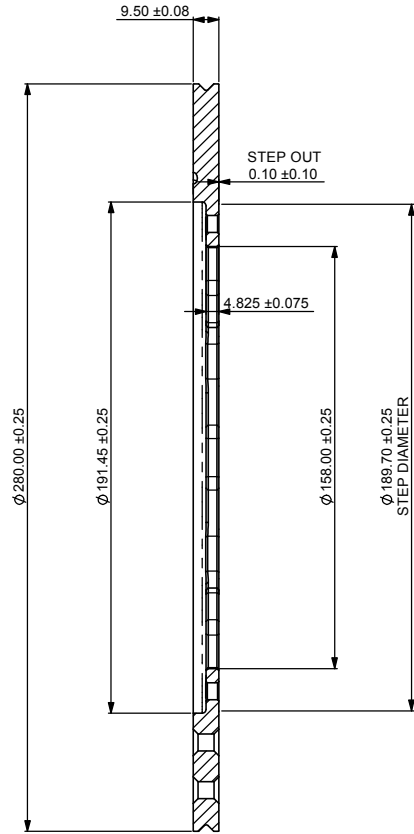

A-A

8 HOLES Ø6.45/6.40 THRO'
EQUISPACED ON 175.00 P.C.D.

D SUFFIX DISC
54 CROSS DRILLED HOLES
CHAMFERED Ø10

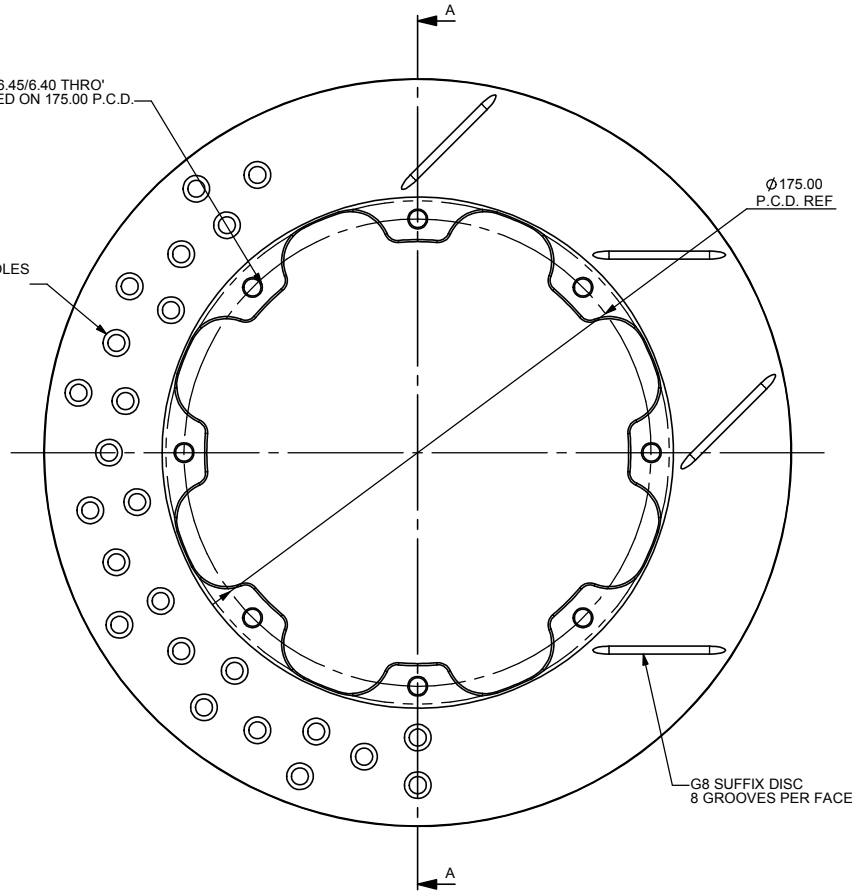

NOTES:
NON HANDED SOLID DISC
APPROXIMATE WEIGHT: 2.2KG

SCALE 1:1	SHEET 1 OF 1
DRAWN	Steve Thomas
APPROVED	
DERIVED FROM	
TITLE	
SOLID DISC	
Ø280 x 9.50	
DRG NO.	CP2866-223 CD