

A1 INSTALLATION DRAWING

IF THIS DOCUMENT IS PRINTED IN HARDCOPY, IT IS FOR INFORMATION USE ONLY AND THEREFORE IS NOT SUBJECT TO UPDATING CONTROLS. ALWAYS REFER TO SOLIDWORKS VIEWER FOR LATEST ISSUE



THIS DRAWING IS CONFIDENTIAL AND IS SUPPLIED ON THE EXPRESS CONDITION THAT IT SHALL NOT BE LOANED OR COPIED OR DISCLOSED TO ANY OTHER PERSON OR USED FOR ANY OTHER PURPOSE WITHOUT THE WRITTEN CONSENT OF AP RACING LTD.



© AP Racing Ltd. 2002
AP Racing
Wheler Road
Coventry
CV3 4LB

Tel: +44 024 7663 9595 e-mail: sales@ap racing.co.uk
Fax: +44 024 7663 9559 Web site: HTTP://www.ap racing.com

SUFFIX TO DISC PART NUMBERS:-

SUFFIX DETAILS

P PLAIN (NO GROOVES)
CGnn CURVED GROOVES AS SHOWN. VALUE nn PER FACE.
eg CG8 MEANS 8 CURVED GROOVES PER FACE.

PART NUMBER	Ø A	DIMN B	Ø C	Ø D	DIMN H	Ø M	WEIGHT Kg	PAD DEPTH
CP5000-110 RH	355.6	35.55	244.6	214.0	6.575	228.6	7.7	D54
CP5000-111 LH								
CP5000-112 RH	330.2	35.55	219.4	190.0	6.575	203.2	7.2	D54
CP5000-113 LH								

FOR DISC MOUNTING TECHNIQUES, BEDDING PROCEDURE AND DISC COOLING RECOMMENDATIONS SEE AP RACING BRAKE DISC CATALOGUE.

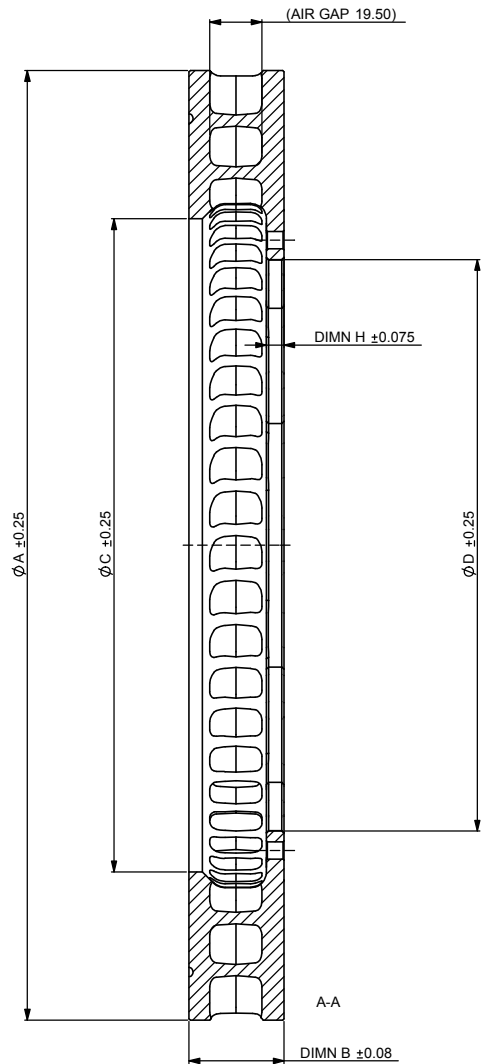
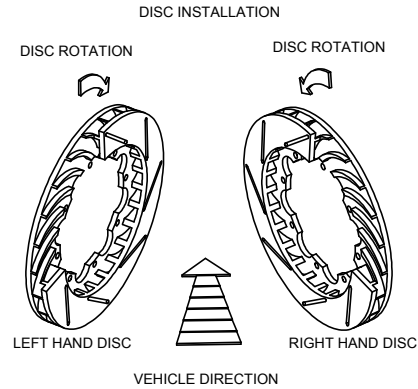

12 HOLES Ø 6.425 ±0.025
EQUI-SPACED ON PCØ M

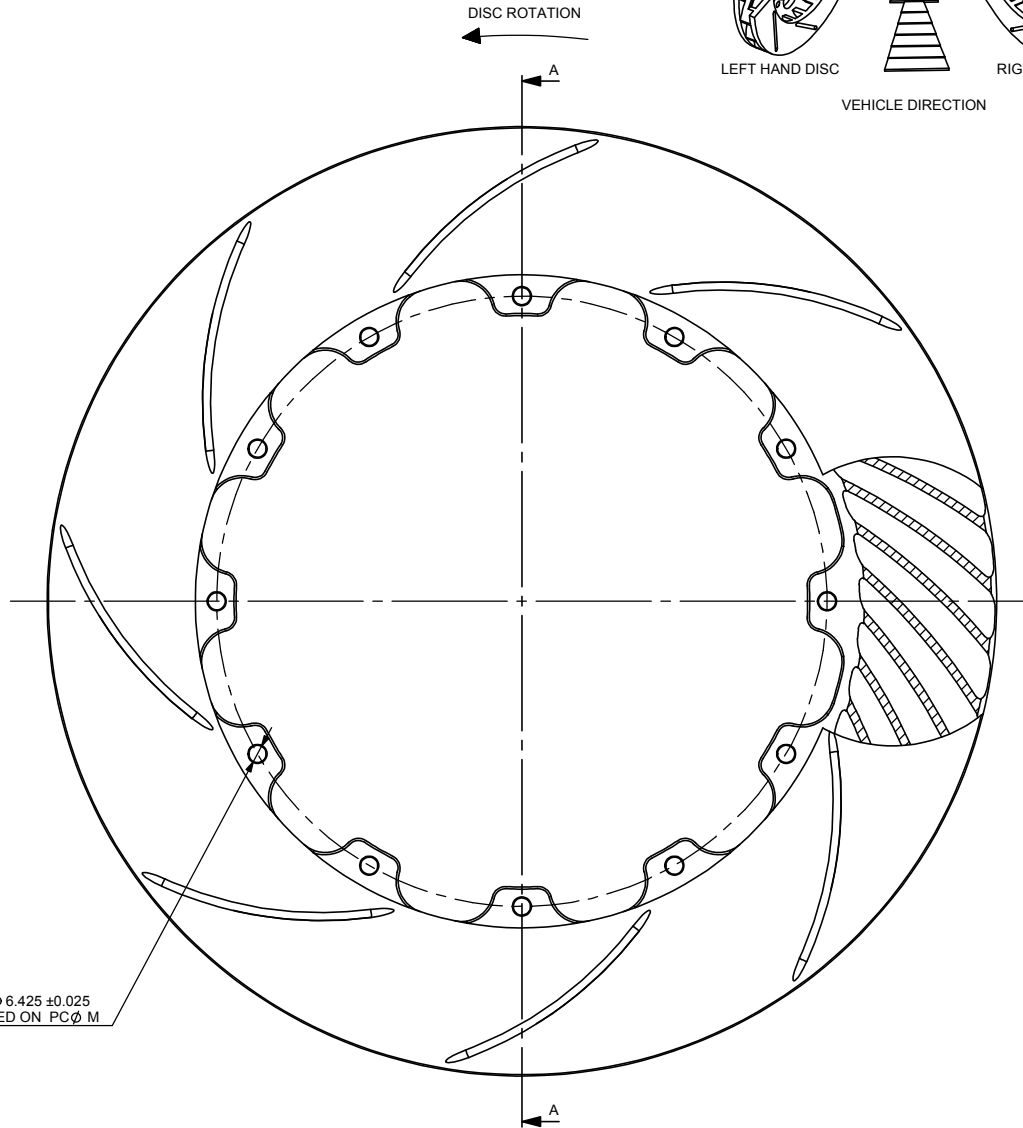

Issue	Alterations		Zone	Initials
	Date & No.	Particulars		
1	17/6/93	FIRST ISSUE	#	AW
2	08/07/02 B3373	RE-DRAWN ON SOLID WORKS. CHART DIMMS UPDATED	#	DRA

SCALE 1:1	SHEET 1 OF 1
DRAWN	D.ARROWSMITH
APPROVED	
DERIVED FROM	
TITLE	
VENTILATED BRAKE DISC INSTALLATION DRAWING	
DRG NO.	CP5000-100CD