

# A1 INSTALLATION DRAWING

IF THIS DOCUMENT IS PRINTED IN HARDCOPY, IT IS FOR INFORMATION USE ONLY AND THEREFORE IS NOT SUBJECT TO UPDATING CONTROLS. ALWAYS REFER TO SOLIDWORKS VIEWER FOR LATEST ISSUE



THIS DRAWING IS CONFIDENTIAL AND IS SUPPLIED ON THE EXPRESS CONDITION THAT IT SHALL NOT BE LOANED OR COPIED OR DISCLOSED TO ANY OTHER PERSON OR USED FOR ANY OTHER PURPOSE WITHOUT THE WRITTEN CONSENT OF AP RACING LTD.



AP Racing  
Wheler Road  
Coventry  
CV3 4LB

Tel: +44 (0) 24 7663 9595  
Fax: +44 (0) 24 7663 9559  
e-mail: [engineering@apracings.com](mailto:engineering@apracings.com)  
Web site: <http://www.apracings.com>

© AP Racing Ltd. 2005

**DISC PART NUMBERS:**

CP5000-312 RH AS SHOWN  
CP5000-313 LH OPPOSITE

THIS IS A 48 VANES DISC OF MASS 3.77kg

THIS DISC WAS DESIGNED TO WORK WITH A D43 DEPTH PAD.

FOR DISC MOUNTING TECHNIQUES, BEDDING PROCEDURE AND DISC COOLING RECOMMENDATIONS SEE AP RACING BRAKE DISC CATALOGUE.

## DISC INSTALLATION

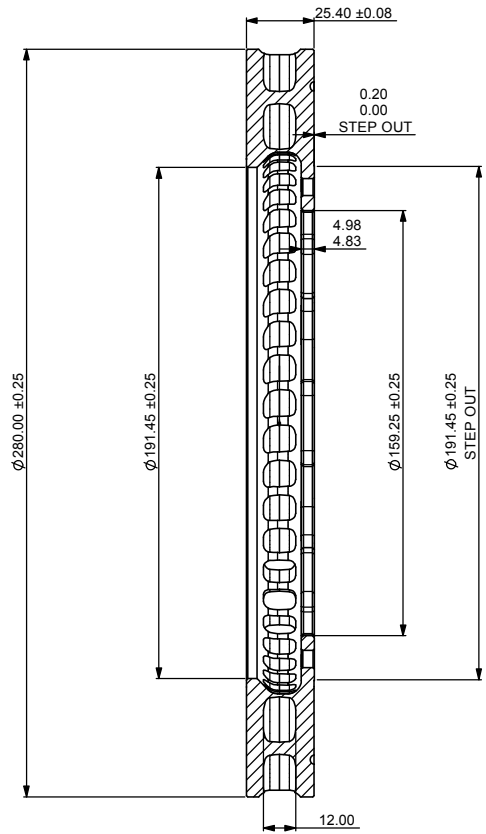
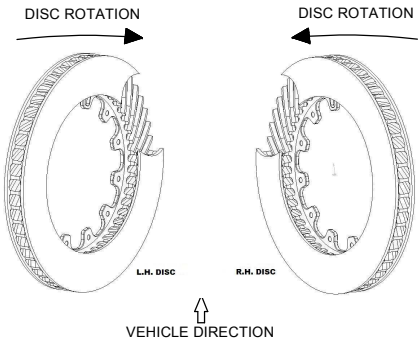

8 HOLES Ø6.45/6.40 THRO'  
EQUISPACED AS SHOWN  
CHAMF' 0.5 x 45° BOTH SIDES

Ø176.75 P.C.D.

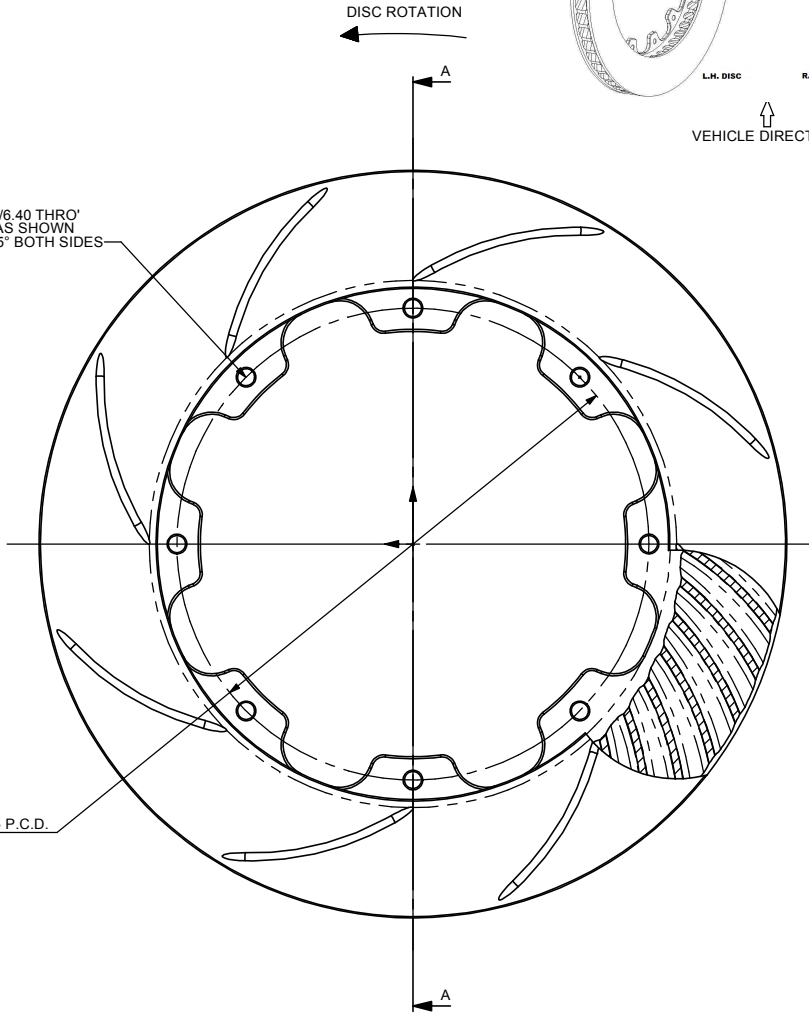

Issue No	Alterations		
	Date & No.	Particulars	Zone
1	14/09/06 B4638	FIRST ISSUE	SAT

SCALE 1:1 SHEET 1 OF 1

DRAWN Steve Thomas  
 APPROVED  
 DERIVED FROM

TITLE  
 Ø280.00 x 25.40  
 CURVED GROOVE DISC

DRG NO. CP5000-312/313CG8