

B1 INSTALLATION DRAWING

IF THIS DOCUMENT IS PRINTED IN HARD COPY, IT IS FOR INFORMATION USE ONLY AND THEREFORE IS NOT SUBJECT TO UPDATING CONTROLS. ALWAYS REFER TO SOLIDWORKS VIEWER FOR LATEST ISSUE



THIS DRAWING IS CONFIDENTIAL AND IS SUPPLIED ON THE EXPRESS CONDITION THAT IT SHALL NOT BE LOANED OR COPIED OR DISCLOSED TO ANY OTHER PERSON OR USED FOR ANY OTHER PURPOSE WITHOUT THE WRITTEN CONSENT OF AP RACING LTD.

© AP Racing Ltd. 2001
 AP Racing
 Wheler Road
 Coventry
 CV3 4LB
 Tel: +44 024 7663 9595 e-mail: sales@apracing.co.uk
 Fax: +44 024 7663 9559 Web site: HTTP://www.apracing.com

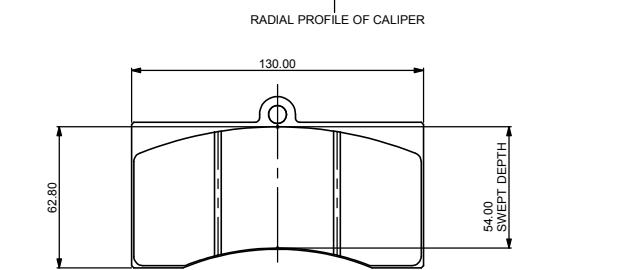
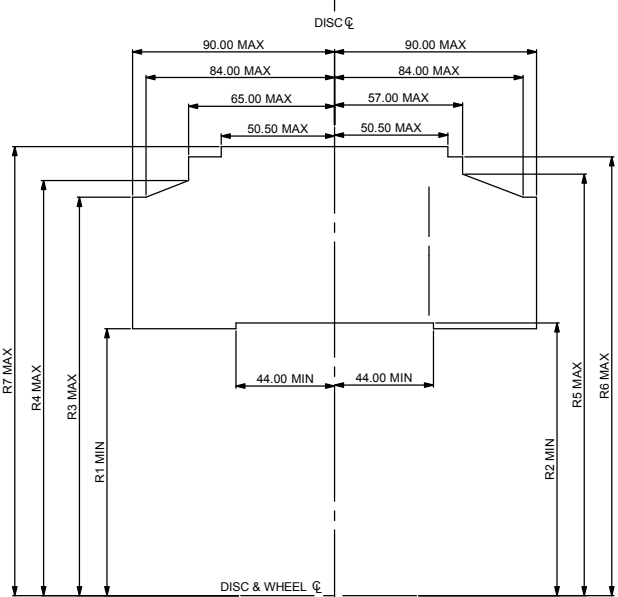
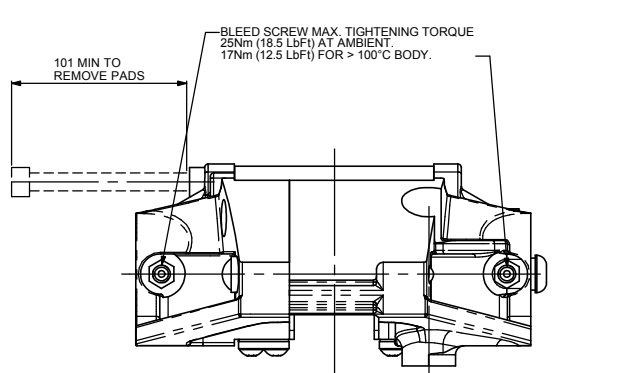

CP3714 PAD FAMILY
 PAD AREA - SLOTTED :- 66.0 cm²
 - FULL AREA :- 69.3 cm²
 PAD THICKNESS :- 25mm

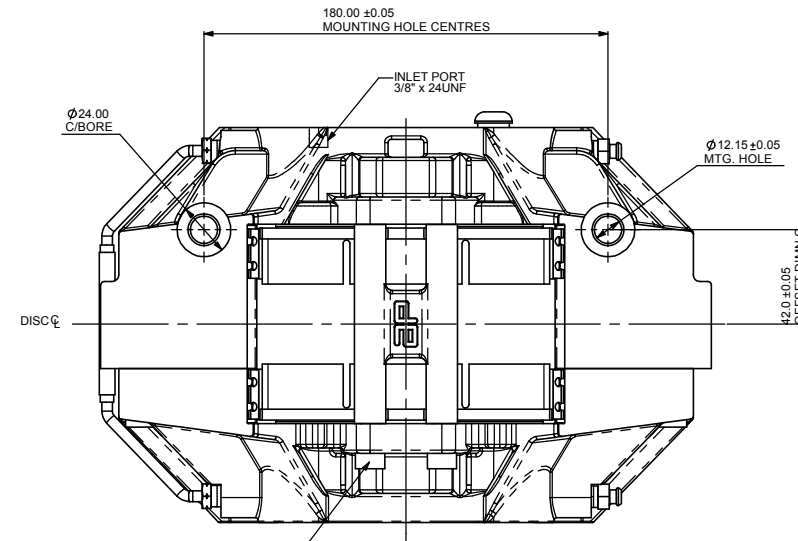
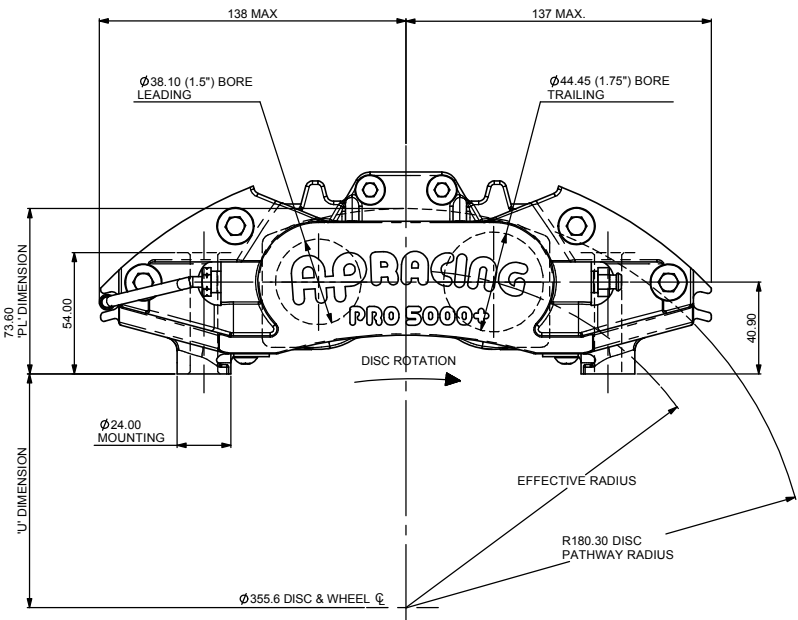

PAD RETAINING BOLT MAX. TORQUE 20 NM (15 LbfF)

GENERAL DESCRIPTION:
 THIS IS A 4 PISTON DIFFERENTIAL BORE CALIPER DESIGNED TO OPERATE ON CAST IRON DISCS OF DIAMETERS Ø330.2 TO Ø355.6 mm AND THICKNESSES 32.0 TO 35.6 mm. STAINLESS STEEL BRIDGE PIPES AND PAD ABUTMENT WEAR PLATES ARE FITTED. SEALS ARE HIGH TEMPERATURE 'SEAL-IN-BORE' TYPE.

TYPICAL APPLICATION:
 GENERAL COMPETITION USE

TECHNICAL INFORMATION:
 TOTAL PISTON AREA: 53.8cm²
 PISTON MATERIAL: ALUMINIUM ALLOY
 BODY MATERIAL: ALUMINIUM ALLOY
 HYDRAULIC CONNECTIONS: 3/8" x 24 UNF
 BRAKE PADS: CP3714 FAMILY
 ASSEMBLY WEIGHT: 3.28 Kg. (WITHOUT PADS)

INSTALLATION INFORMATION:
 DISC & CALIPER MOUNTING TOLERANCES TO BE SUCH THAT THE DISC IS CENTRAL TO THE CALIPER TO WITHIN ±0.5 mm.

KEY TO DIMENSIONS:
 DIMENSION 'PL': TOP OF PAD MATERIAL TO MOUNTING BOSS FACE WITH PAD SITTING DOWN ON LEDGE.
 DIMENSION 'U': WHEEL CENTRE LINE TO CALIPER MOUNTING BOSS FACE = (DISC Ø/2) - DIMENSION 'PL'.
 DIMENSION 'C': OFFSET-DISC CENTRE LINE TO MOUNTING HOLES.
 EFFECTIVE RAD: DISTANCE FROM WHEEL CENTRE LINE TO NOMINAL PISTON CENTRE LINE.

AP RACING TECHNICAL SECTION WILL BE PLEASED TO ADVISE ON THE MOST SUITABLE EQUIPMENT FOR ANY PARTICULAR APPLICATION.

CALIPER PART NUMBERS
 CP5040-20S4 - RIGHT HAND TRAILING (AS DRAWN)
 CP5040-21S4 - LEFT HAND TRAILING
 CP5040-22S4 - RIGHT HAND LEADING
 CP5040-23S4 - LEFT HAND LEADING

THE ADDITION OF AN 'L' SUFFIX DENOTES STAINLESS STEEL PISTONS RATHER THAN THE STANDARD ALUMINIUM ALLOY PISTONS

REPLACEMENT SEAL KIT

Rev	Alterations			Zone	Initials
	Date & No.	Particulars	#		
1	14/05/03 B3649	FIRST ISSUE			SAT
2	15/02/07 B4750	CALIPER PART No 'L' SUFFIX NOTE ADDED			SAT

SCALE 1:1 SHEET 1 OF 1

DRAWN Steve Thomas

APPROVED

DERIVED FROM

TITLE
 4 PISTON CALIPER
 INSTALLATION DRAWING

DRG NO. CP5040-20cd

DISC Ø	DISC WIDTH	R1	R2	R3	R4	R5	R6	R7	EFF RAD	U' DIM'N
355.6	35.6 TO 32.0	119.0	121.5	177.5	185.0	187.9	195.5	200.1	150.3	104.2
330.2	35.6 TO 32.0	107.0	109.5	165.5	173.0	175.5	182.5	188.3	137.1	91.5