

B1 INSTALLATION DRAWING

IF THIS DOCUMENT IS PRINTED IN HARDCOPY, IT IS FOR INFORMATION USE ONLY AND THEREFORE IS NOT SUBJECT TO UPDATING CONTROLS. ALWAYS REFER TO SOLIDWORKS VIEWER FOR LATEST ISSUE



THIS DRAWING IS CONFIDENTIAL AND IS SUPPLIED ON THE EXPRESS CONDITION THAT IT SHALL NOT BE LOANED OR COPIED OR DISCLOSED TO ANY OTHER PERSON OR USED FOR ANY OTHER PURPOSE WITHOUT THE WRITTEN CONSENT OF AP RACING LTD.

AP Racing
Wheler Road
Coventry
CV3 4LB
Tel: +44 024 7663 9595
Fax: +44 024 7663 9559
e-mail: sales@apracings.co.uk
Web site: HTTP://www.apracings.com

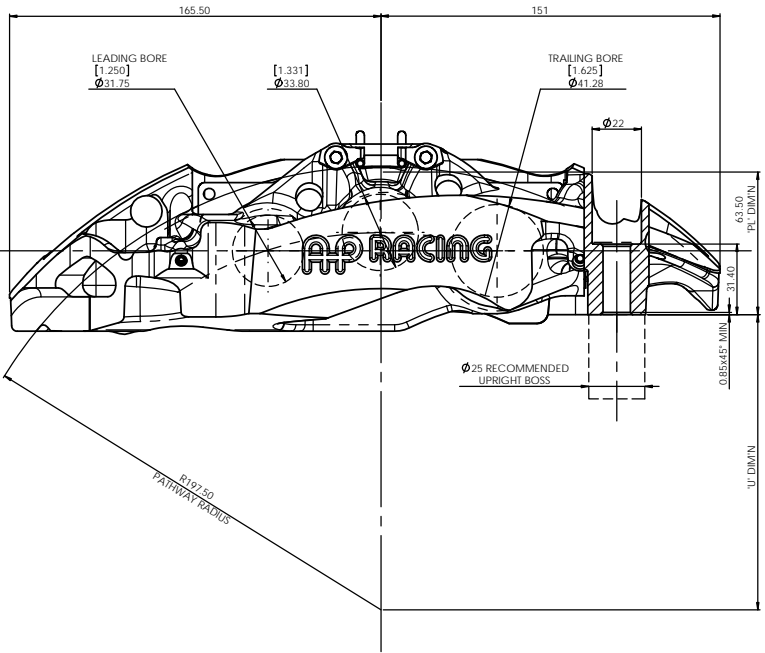
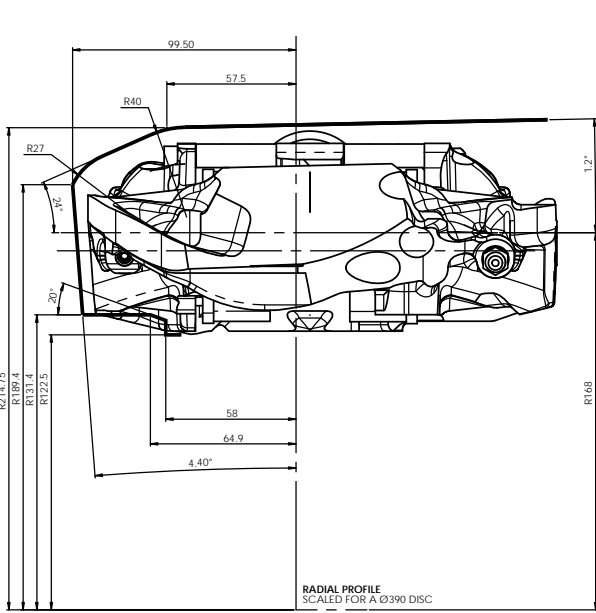

GENERAL DESCRIPTION
6 PISTON DIFFERENTIAL BORE CALIPER TO SUIT UP TO Ø390 x 35.6MM IRON DISC. PADS ARE RETAINED BY A BOLTED RETAINER, WITH A QUICK-RELEASE SPRING CLIP SUPPLIED FOR USE IN EVENTS WHEN FAST PAD CHANGES ARE REQUIRED.

TYPICAL APPLICATION - GT3

TECHNICAL INFORMATION & INSTALLATION DATA
TOTAL PISTON AREA (6) - 60.75cm²
PISTON MATERIAL - STAINLESS STEEL
BODY MATERIAL - ALUMINIUM ALLOY
ASSEMBLY WEIGHT LESS PADS WITH BOTH PAD RETAINERS - 3.3KG
MAX STACK = 35.56mm DISC + 2x 30mm PADS = 95.56MM
MIN STACK = 47.50mm

INSTALLATION INFORMATION
DISC & CALIPER MOUNTING TOLERANCES TO BE SUCH THAT THE DISC IS CENTRAL TO THE CALIPER TO WITHIN ±0.5mm.
CALIPER TO BE MOUNTED WITHIN ±15° FROM VERTICAL.
DISC DIAMETRAL CLEARANCE SHOULD BE 2.5mm NOM. FROM DISC O.D. TO PATHWAY.

KEY TO DIMENSIONS
‘PL’ - TOP OF PAD MATERIAL TO MOUNTING BOSS FACE WITH PAD SITTING DOWN ON LEDGE.
‘U’ - WHEEL CENTRE LINE TO CALIPER MOUNTING BOSS FACE (DISC Ø/2) DIMENSION ‘PL’.

CALIPER PART NUMBERS
CP6269-25TL - RIGHT HAND TRAILING (BEHIND AXLE)
CP6269-35TL - LEFT HAND TRAILING (BEHIND AXLE)

EXAMPLE PART # - CP6269-2 S (SIDE FEED) 7 (7lb AKB SPRINGS) L (STAINLESS PISTONS).
RECOMMENDED DISC AND PAD OPTIONS AVAILABLE
D54 DISC AND PAD COMBINATION

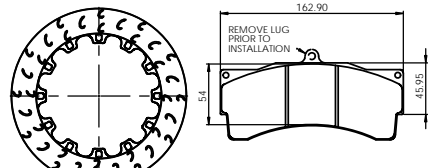

CP4284-134 RH & -135 LH VENTILATED DISC
PAD DEPTH - D54
DIAMETER - 390MM
THICKNESS - 35.56MM

CP6210D54 FAMILY IRON PAD
PAD AREA - SLOTTED - 81.7cm²
FULL AREA - 84.4cm²
THICKNESS - 30MM

FOR GROOVE OPTIONS AND MORE DETAILS SEE CP4284-134-5CD

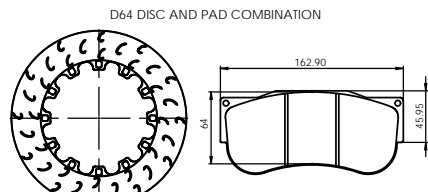

CP4284-136 RH & -137 LH VENTILATED DISC
PAD DEPTH - D64
DIAMETER - 390MM
THICKNESS - 35.56MM

CP6210D64 FAMILY IRON PAD
PAD AREA - SLOTTED - 90.5cm²
FULL AREA - 93.7cm²
THICKNESS - 30MM

FOR GROOVE OPTIONS AND MORE DETAILS SEE CP4284-136-7CD

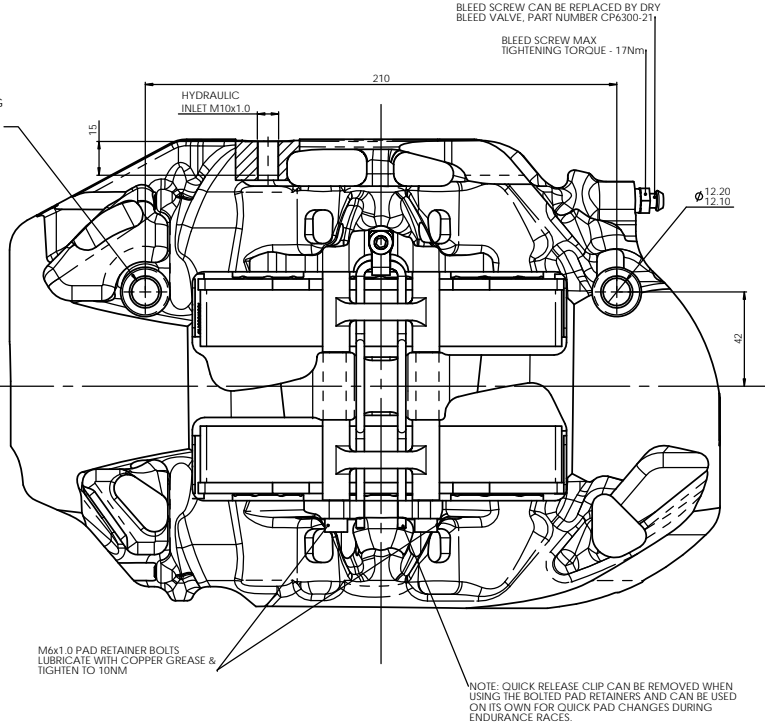
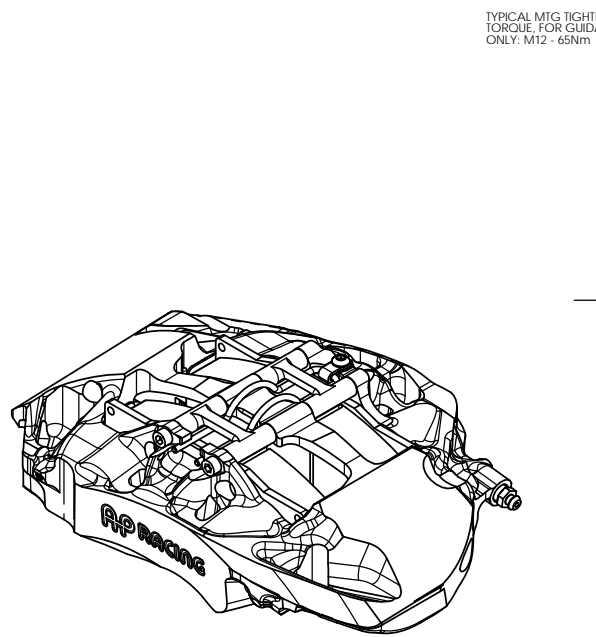
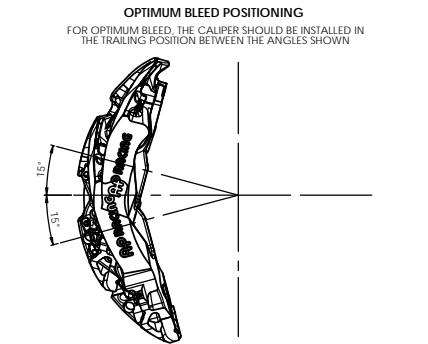

TYPICAL MTG TIGHTENING TORQUE, FOR GUIDANCE ONLY: M12 - 65Nm

M6x1.0 PAD RETAINER BOLTS LUBRICATE WITH COPPER GREASE & TIGHTEN TO 10NM

NOTE: QUICK RELEASE CLIP CAN BE REMOVED WHEN USING THE BOLTED PAD RETAINERS AND CAN BE USED ON ITS OWN FOR QUICK PAD CHANGES DURING ENDURANCE RACES.

Issue No	Alterations			Zone	Initials
	Date & No.	Particulars			
1	25/02/14 B0719	FIRST ISSUE			SAT
2	04/08/14 B7068	D64 PAD OPTION ADDED			NJS
3	12/08/14 B7137	DRAWING UPDATED TO CURRENT AP RACING STANDARD RECOMMENDED DISC AND PADS ADDED FITTING INSTRUCTIONS ADDED ON SHEET 2			JN
4	09/03/15 RA022152	MAX / MIN STACK ADDED			NJS
5	10/12/15 B7344	SHEET 2 CP6269-112 ADDED TO PARTS LIST CP6269-113 ADDED TO PARTS LIST CP6269-114 ADDED TO PARTS LIST NOTE ADDED TO AID PART SECTION DETAILED VIEW ADDED	14L 14L 14M 1P 5N		THS
6	15/01/18 B7749	PICTORIAL UPDATE TO REFLECT CHANGE OF FORGING AND BALL & GRUB PORTING			SAT
7	19/04/18 B7889_01	33.80 WAS 34.00 SHEET 2 CHANGED PISTON SIZE TO 33.70 FROM 34.00	N9 N12		SGW

SCALE 1:1 SHEET 1 OF 2

DRAWN Steve Thomas

APPROVED

DERIVED FROM

TITLE
GT3 6 PIST
BRAKE CALIPER

DRG NO. CP6269-1CD

B1 INSTALLATION DRAWING

IF THIS DOCUMENT IS PRINTED IN HARDCOPY, IT IS FOR INFORMATION USE ONLY AND THEREFORE IS NOT SUBJECT TO UPDATING CONTROLS. ALWAYS REFER TO SOLIDWORKS VIEWER FOR LATEST ISSUE



THIS DRAWING IS CONFIDENTIAL AND IS SUPPLIED ON THE EXPRESS CONDITION THAT IT SHALL NOT BE LOANED OR COPIED OR DISCLOSED TO ANY OTHER PERSON OR USED FOR ANY OTHER PURPOSE WITHOUT THE WRITTEN CONSENT OF AP RACING LTD.



AP Racing
Wheler Road
Coventry
CV3 4LB
Tel: +44 024 7663 9595
Fax: +44 024 7663 9559
e-mail: sales@apracings.co.uk
Web site: HTTP://www.apracings.com

FOR CALIPERS WITH '01A' TO '01I' IN PART NUMBER SUFFIX IN POSITION SHOWN, SEE DETAIL B. USE THE FOLLOWING PARTS:
PAD SUPPORTS - CP6269-104
LEADING PAD ABUTMENT PLATES - CP6269-102
TRAILING PAD ABUTMENT PLATES - CP6269-103

FOR CALIPERS WITH PART NUMBER SUFFIX '01M' AND ONWARDS USE THE FOLLOWING PARTS:
PAD SUPPORTS - CP6269-114
LEADING PAD ABUTMENT PLATES - CP6269-112
TRAILING PAD ABUTMENT PLATES - CP6269-113

DETAIL B
SCALE 2.6:1

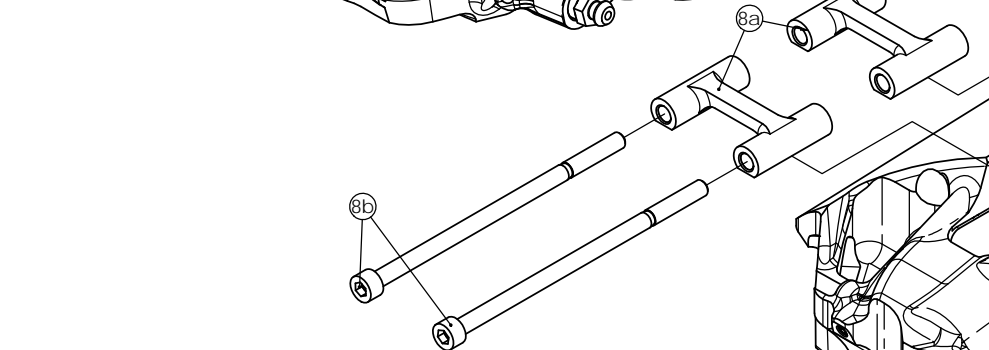
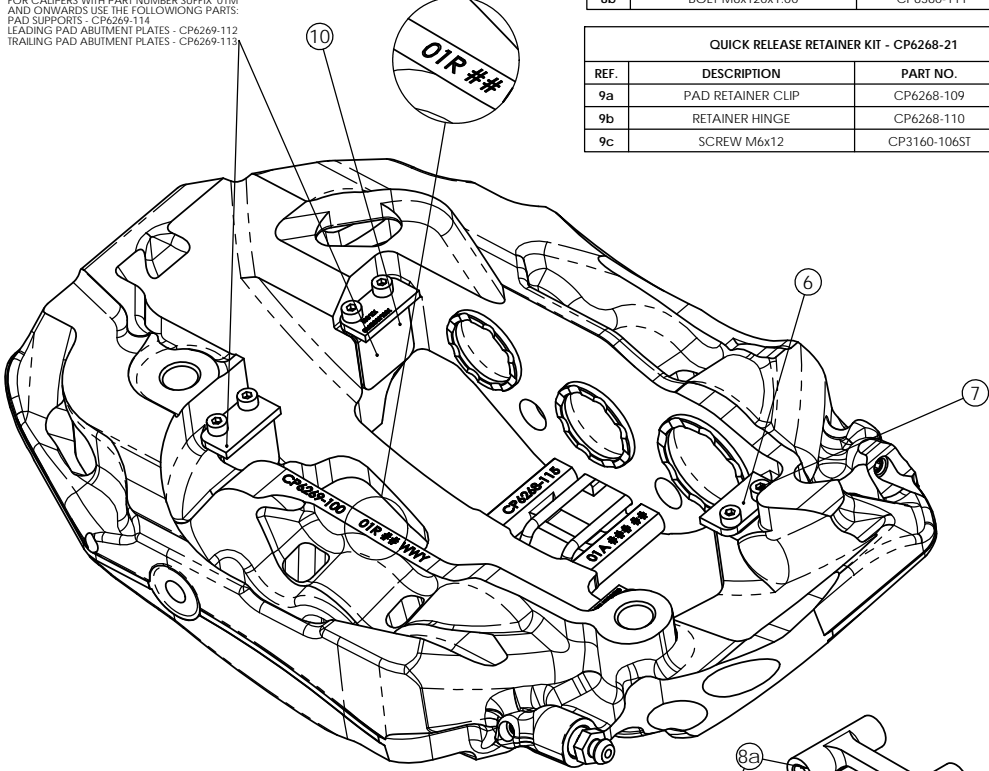

PAD RETAINER KIT - CP6268-20			
REF.	DESCRIPTION	PART NO.	QTY
8a	PAD RETAINER	CP6268-115	2
8b	BOLT M6x120x1.00	CP6360-111	2

QUICK RELEASE RETAINER KIT - CP6268-21			
REF.	DESCRIPTION	PART NO.	QTY
9a	PAD RETAINER CLIP	CP6268-109	1
9b	RETAINER HINGE	CP6268-110	1
9c	SCREW M6x12	CP3160-106ST	1

CP6269-2/3/7L SPARES				
REF	DESCRIPTION	PART NO.	QTY / ASSY	FITTING INSTRUCTIONS
1	Ø1 1/4" SST PISTON	CP6268-104	2	
2	Ø33.7MM SST PISTON	CP6268-105	2	
3	Ø1 5/8" SST PISTON	CP6268-106	2	
4	SEAL KIT (6 SEALS)	CP8518-EFK	1	REFER TO PUBLICATION REF: P14.290 & P14.220
5	BLEED SCREW KIT	CP3880-1	1	TIGHTENING TORQUE - 17Nm
6	PAD SUPPORT	CP6269-104 OR CP6269-114 SEE NOTE	4	
7	M4x0.7 SOCKET HEAD CAP SCREW	CP3215-115	8	APPLY A 1-2MM DROP OF LOCTITE 270 TO THE 2ND FROM LAST THREAD WHEN FITTING. TIGHTENING TORQUE 4Nm
10	PAD ABUTMENT PLATE	CP6269-102 LEADING CP6269-103 TRAILING OR CP6269-112 LEADING CP6269-113 TRAILING SEE NOTE	2 2 2 2	APPLY 736 RTV SILICONE SPARINGLY BEHIND THE ABUTMENT PLATE ENSURING ENTIRE CONTACT FACE IS COVERED APPLY PRESSURE TO ABUTMENT PLATE WHEN FITTING. TO ENSURE MINIMUM FILM THICKNESS AND AVOID ANY GAP. ENSURE ABUTMENT PLATE SITS CORRECTLY AGAINST CALIPER BODY BEFORE FITTING RETAINING SCREWS
11	7Lb AKB SPRING	CP4100-121	4	
12	7Lb AKB SPRING	CP2667-113	2	

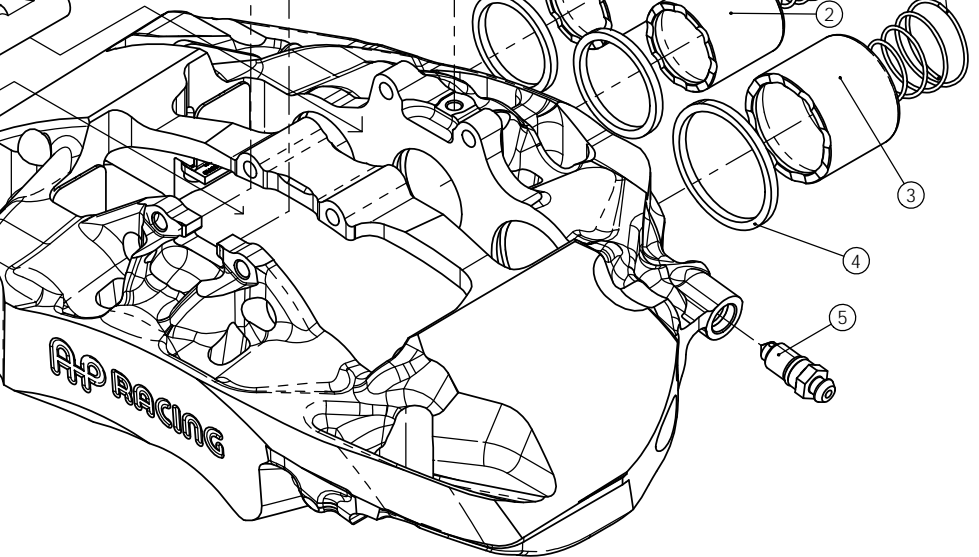

Issue No.	Alterations		
	Date & No.	Particulars	Zone / Initials
-		SEE SHEET 1 FOR ISSUE INFORMATION.	

SCALE 1:2	SHEET 2 OF 2
DRAWN	Steve Thomas
APPROVED	
DERIVED FROM	
TITLE GT3 6 POT BRAKE CALIPER	
DRG NO.	CP6269-1CD