

B1 INSTALLATION DRAWING

IF THIS DOCUMENT IS PRINTED IN HARDCOPY, IT IS FOR INFORMATION USE ONLY AND THEREFORE IS NOT SUBJECT TO UPDATING CONTROLS. ALWAYS REFER TO SOLIDWORKS VIEWER FOR LATEST ISSUE



THIS DRAWING IS CONFIDENTIAL AND IS SUPPLIED ON THE EXPRESS CONDITION THAT IT SHALL NOT BE LOANED OR COPIED OR DISCLOSED TO ANY OTHER PERSON OR USED FOR ANY OTHER PURPOSE WITHOUT THE WRITTEN CONSENT OF AP RACING LTD.



© AP Racing Ltd. 2000
 AP Racing
 Wheler Road
 Coventry
 CV3 4LB

Tel: +44 024 7663 9595 e-mail: sales@apracing.co.uk
 Fax: +44 024 7663 9559 Web site: HTTP://www.apracing.com

CALIPER SPECIFICATION

BORE SIZE	27.00 X 31.75 X 38.10 (1.06" X 1.25" X 1.50")
PISTON AREA / PAD	25.2 SQ. CM
DISC DIA. MAX.	362.00
DISC THICKNESS MAX.	32.00
DISC THICKNESS MIN. (WORN CONDITION)	30.00 (DIFFERENTIAL WEAR NOT TO EXCEED 0.50MM SIDE TO SIDE)
WORKING PRESSURE MAX.	120 bar
HYDRAULIC FEED	M10 X 1.0
DRY WEIGHT (LESS PADS)	3.70kg
PAD FAMILY	CP7040
EFFECTIVE RADIUS (ON DIA. 330.00 DISC)	152.00
'PL' DIMN.	68.80
OFFSET 'C' DIMN.	53.2
MTG. HOLE CENTRES 'D' DIMN.	152.00
PAD FRICTION MATERIAL MIN. THICKNESS	2.50
PAD RETENTION	2 X FRICTION RETAINED PINS
TIGHTENING TORQUES	BLEED SCREW : 17Nm HYDRAULIC FEED : 25Nm
CORROSION PROTECTION	FLUID RESISTANT BLACK PAINT FINISH - ALUMINIUM BODY BOOT TYPE DIRT SEALS

CALIPER IDENTIFICATION CHART

RHT	RIGHT HAND TRAILING (BEHIND AXLE)
LHT	LEFT HAND TRAILING (BEHIND AXLE)
RHL	RIGHT HAND TRAILING (IN FRONT OF AXLE)
LHL	LEFT HAND TRAILING (IN FRONT OF AXLE)

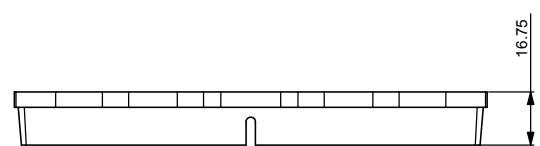
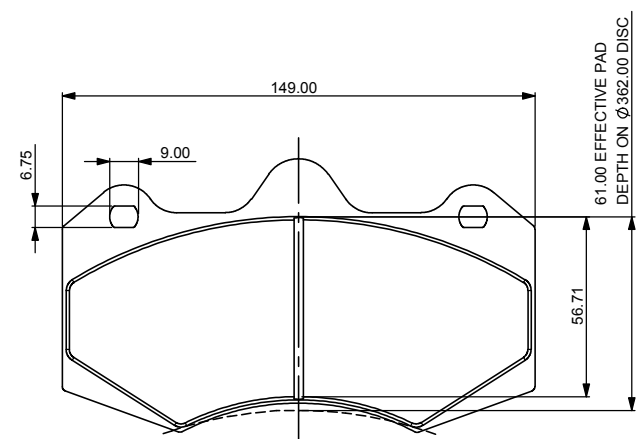
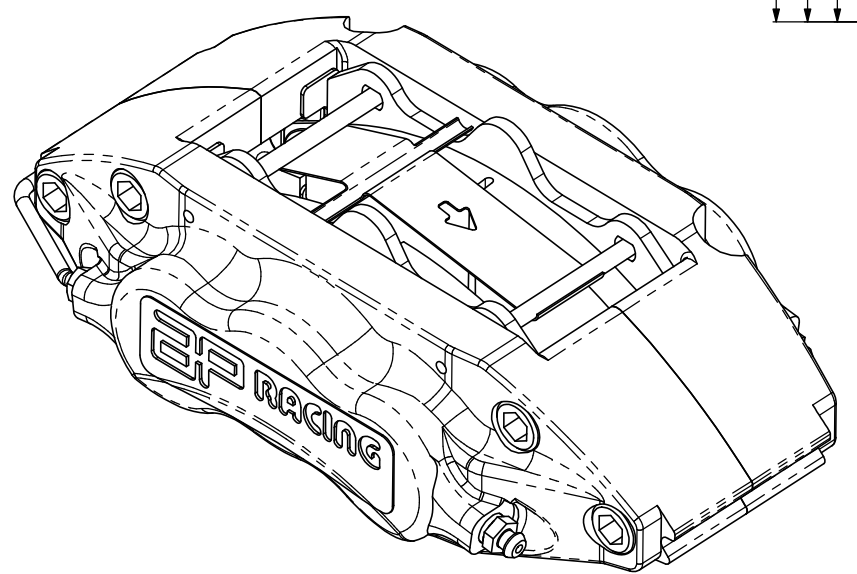
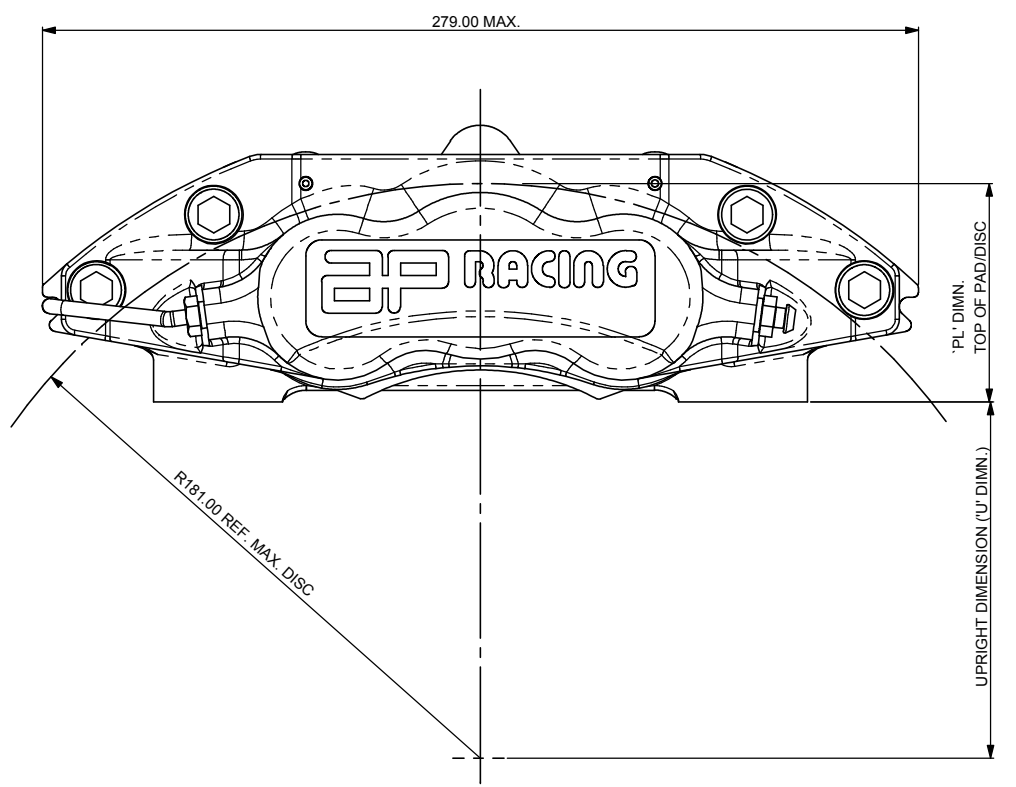
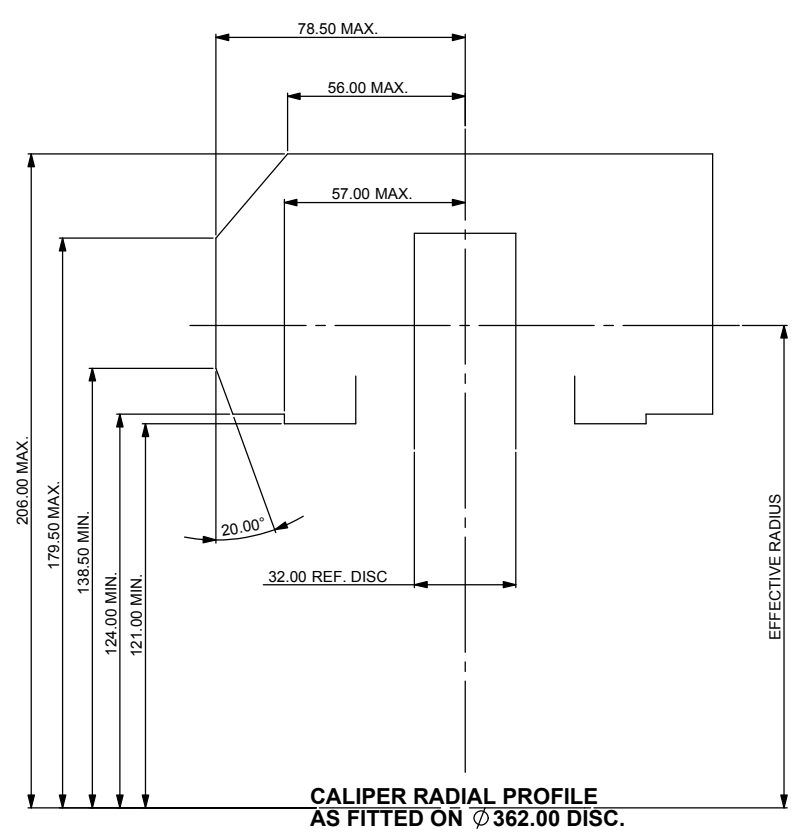

CP7040 PAD FAMILY
 PAD AREA (MAX.) - 75 SQ. CM

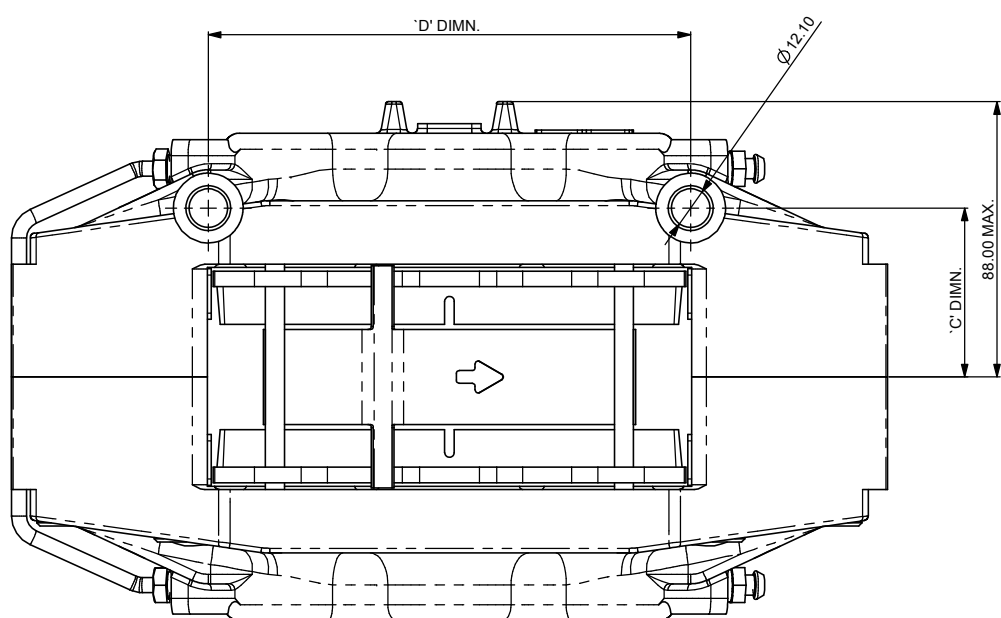

PART NUMBERING CONVENTION

PART NUMBER	DESCRIPTION
CP7040-2S0	RHT - SIDE FEED - NO ANTI KNOCK BACK SPRING
CP7040-3S0	LHT - SIDE FEED - NO ANTI KNOCK BACK SPRING
CP7040-4S0	RHL - SIDE FEED - NO ANTI KNOCK BACK SPRING
CP7040-5S0	LHL - SIDE FEED - NO ANTI KNOCK BACK SPRING

Issue No	Date & No.	Particulars	Zone	Initials
1	23/11/01 R0887	FIRST ISSUE	#	#

SCALE 1:1	SHEET 1 OF 1
DRAWN	Jon Simmonds
APPROVED	
DERIVED FROM	
TITLE	CALIPER INSTALLATION DRAWING 362 MAX. X 32 DISC INSTALLATIONS
DRG NO.	cp7040-1cd