

# A1 INSTALLATION DRAWING

IF THIS DOCUMENT IS PRINTED IN HARDCOPY, IT IS FOR INFORMATION USE ONLY AND THEREFORE IS NOT SUBJECT TO UPDATING CONTROLS. ALWAYS REFER TO SOLIDWORKS VIEWER FOR LATEST ISSUE



THIS DRAWING IS CONFIDENTIAL AND IS SUPPLIED ON THE EXPRESS CONDITION THAT IT SHALL NOT BE LOANED OR COPIED OR DISCLOSED TO ANY OTHER PERSON OR USED FOR ANY OTHER PURPOSE WITHOUT THE WRITTEN CONSENT OF AP RACING LTD.



AP Racing  
Wheler Road  
Coventry  
CV3 4LB

Tel: +44 (0) 24 7663 9595  
Fax: +44 (0) 24 7663 9559  
e-mail: engineering@apracings.co.uk  
Web site: http://www.apracings.com

© AP Racing Ltd. 2005

Issue No.	Alterations		Zone	Initials
	Date & No.	Particulars		
1	24/09/01 C1903	FIRST ISSUE	#	JG
2	10/03/03	CP7212-CL01-FN AND CP7212-CH01-FN DELETED. CP7212-CL01-FN AND CP7212-CH01-FN ADDED.	#	JG
3	12/05/05 C2678	CP7212-CE01-FN ADDED.	#	JG
4	18/07/06 C2939	110° WAS 45° (x2) R0.30 MAX WAS R1.75 MAX. 31.30/30.60 WAS 31.75 MAX.	K7 E13 E11	JG
5	07/11/06 C3008	TH SPEC AND NOTE C ADDED.	#	JG
6	17/12/12	NOTE 'D' ADDED CONTAINING DETAILS OF CP7212-CE13-FN	#	JG
7	27/02/17 RAC22221	CL01-FN & TH01-FN CLUTCHES REMOVED.  CH01-FN 'SET UP HEIGHT NEW' CHANGED FROM 30.63 - 28.96 TO 30.70 - 28.97MM. CH01-FN 'SET UP HEIGHT WORN' CHANGED FROM 33.94 TO 34.15MM.  CE01-FN 'WEAR IN' CHANGED FROM 0.75 TO 0.50MM. CE01-FN 'SET UP HEIGHT NEW' CHANGED FROM 30.78 - 28.81 TO 31.09 - 29.07MM. CE01-FN 'SET UP HEIGHT WORN' CHANGED FROM 34.19 TO 33.31MM.	#	WJB

12 MOUNTING HOLES Ø8.15/8.05  
EQUI-SPACED AS SHOWN ON A  
Ø214.00 P.C.  
± 0.05

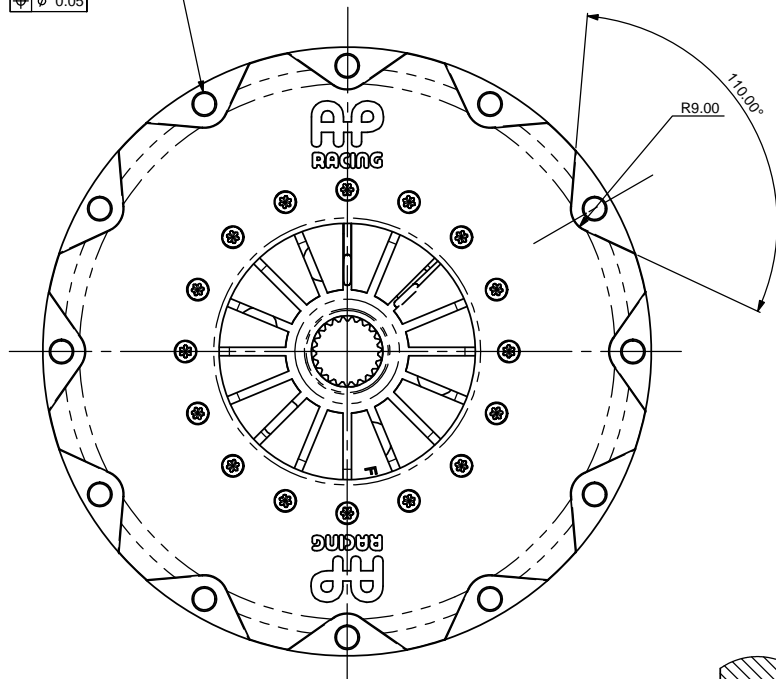

THIS 2 PLATE CARBON / CARBON CLUTCH IS INTERCHANGEABLE WITH CP3921-4GRY A Ø200mm SINGLE PLATE CERAMETALIC CLUTCH ASSEMBLY.

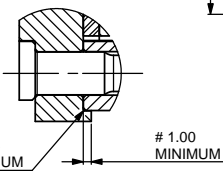

DETAIL B  
SCALE 2 : 1

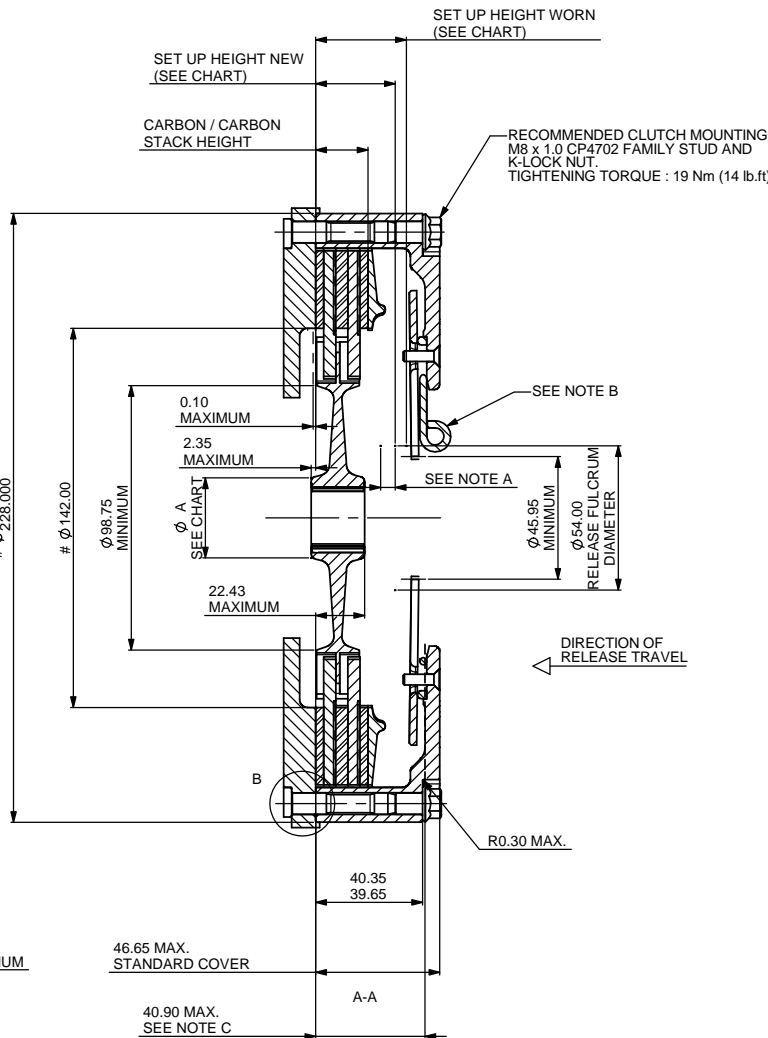

**NOTE A :**  
RELEASE TRAVEL TO BE LIMITED TO 5.50mm MAXIMUM.

**NOTE B :**  
INSTALLATION WIRE FOR USE WHEN INSTALLING CLUTCH TO ENSURE FLYWHEEL SIDE CARBON PLATE IS LOCATED ON THE COVER LUGS.

**THIS WIRE MUST BE REMOVED BEFORE USE.**  
  
# - FLYWHEEL DIMENSIONS.  
ALTERNATIVE CLUTCH MOUNTING: CAP HEAD BOLT (C BORED TREAD) TIGHTENING TORQUE 22.0 Nm (16 lb ft)

CLUTCH PART No. SUFFIX	CP7212-CH01-FN	CP7212-CE01-FN SEE NOTE D
MAXIMUM DYNAMIC TORQUE CAPACITY Nm (lb/ft)	700 (522)	911 (671)
MAXIMUM WEAR IN #	1.00	0.50
RELEASE LOAD (MAX PEAK WORN) daN	375	375
RELEASE LOAD (AT TRAVEL) daN	250	250
SET UP HEIGHT NEW	30.70 28.97	31.09 29.07
SET UP HEIGHT WORN	34.15	33.31

HUB DETAILS		
HUB PART No.	SPLINE DETAIL	ØA' MAX.
CP4202-122	1.00" x 23	30.25
CP4202-127	0.875" x 20	27.25
CP4202-128	29.0 x 10	34.25
CP4202-148	24.0 x 22	30.25

HUBS ARE AVAILABLE WITH OTHER SPLINE SIZES.

ASSEMBLY MASS AND INERTIA		
ASSEMBLY MASS (kg)	ASSEMBLY INERTIA (kgm <sup>2</sup> )	DRIVEN PLATES & HUB INERTIA (kgm <sup>2</sup> )
2.94	0.01903	0.003126

BASED ON ASSEMBLY CP7212SALHT (HIGHEST MASS AND INERTIA IN THIS FAMILY), WITH A STEEL HUB. OTHER VALUES AVAILABLE UPON REQUEST.

NOTE D: THIS ASSEMBLY IS AVAILABLE WITH A STEEL COVER. THE PART No. FOR THIS ASSEMBLY IS CP7212-CE13-FN. ASSEMBLY WEIGHT = 4.29 kg. ASSEMBLY INERTIA = 0.03243 kgm<sup>2</sup>. ALL OTHER INSTALLATION DETAILS AS CP7212-CE01-FN

PRESSURE PLATE KIT (STEEL)		
STANDARD	CP4212-4S (1.00 TO 5.00, 1.00 STEPS)	CP4222-7S (0.75 - 5.25, 0.75 STEPS)
INTERMEDIATE	CP4212-5S (0.50 - 4.50, 1.00 STEPS)	CP4222-5S (0.25 - 5.00, 0.25 STEPS)

SCALE 1:1	SHEET 1 OF 1
DRAWN	Jeremy Govan
APPROVED	
DERIVED FROM	
TITLE	
Ø200mm CARBON / CARBON 2 PLATE CLUTCH INSTALLATION	
DRG NO.	CP7212CD