

# A1 INSTALLATION DRAWING

IF THIS DOCUMENT IS PRINTED IN HARDCOPY, IT IS FOR INFORMATION USE ONLY AND THEREFORE IS NOT SUBJECT TO UPDATING CONTROLS. ALWAYS REFER TO SOLIDWORKS VIEWER FOR LATEST ISSUE



THIS DRAWING IS CONFIDENTIAL AND IS SUPPLIED ON THE EXPRESS CONDITION THAT IT SHALL NOT BE LOANED OR COPIED OR DISCLOSED TO ANY OTHER PERSON OR USED FOR ANY OTHER PURPOSE WITHOUT THE WRITTEN CONSENT OF AP RACING LTD.

AP Racing  
Wheler Road  
Coventry  
CV3 4LB  
Tel: +44 (0) 24 7663 9595  
Fax: +44 (0) 24 7663 9559  
e-mail: engineering@apracings.co.uk  
Web site: http://www.apracings.com

© AP Racing Ltd.

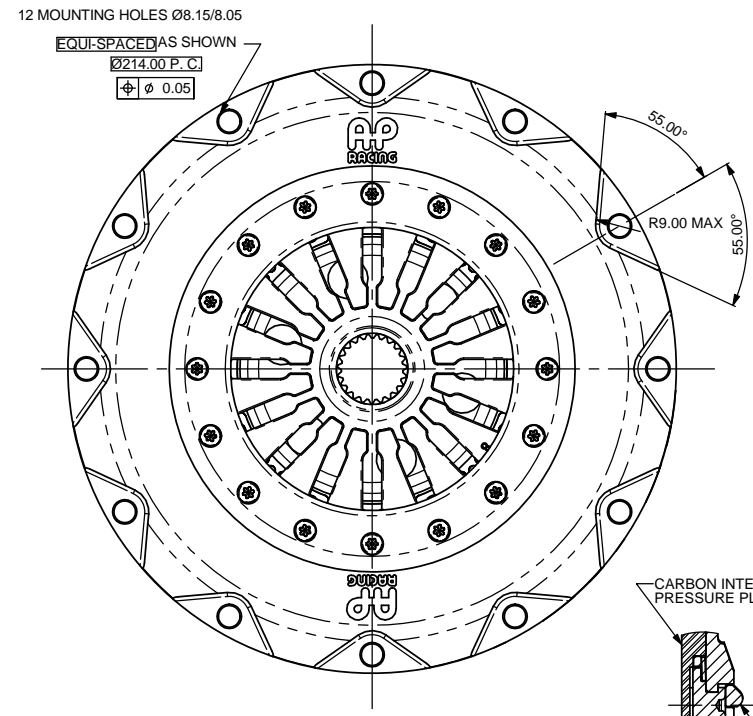

## DETAIL OF OPTIONAL CUSHION- SUFFIX -FP

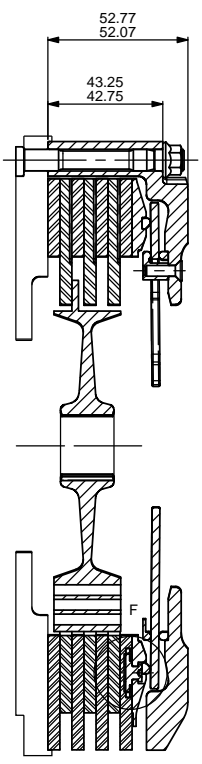

## STANDARD ASSEMBLY SUFFIX - FN

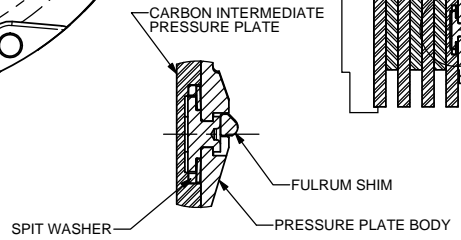
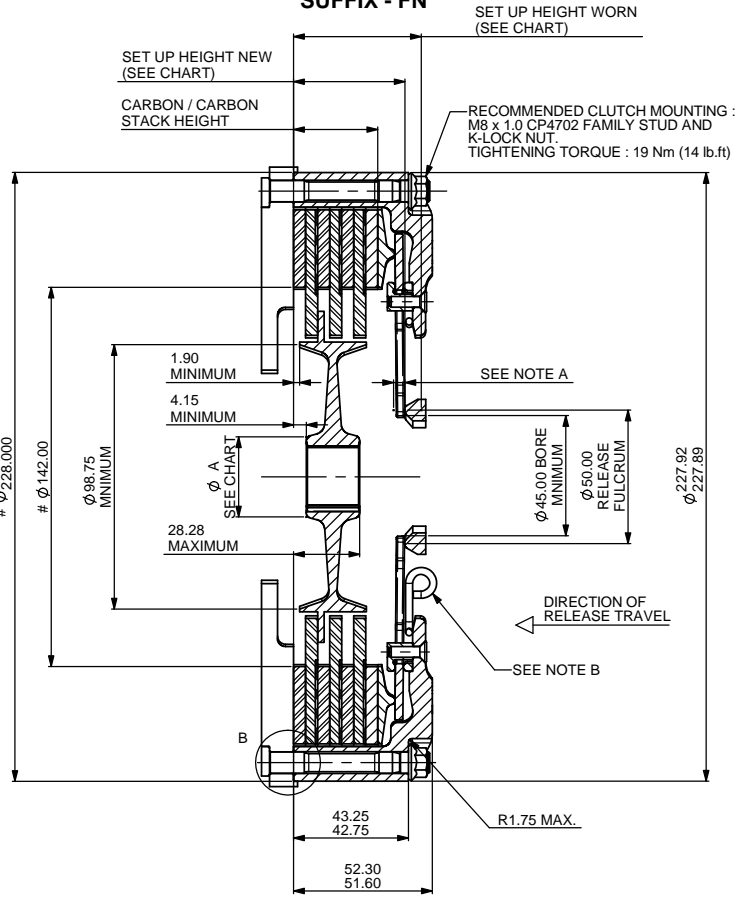

DETAIL F SCALE 2 : 1

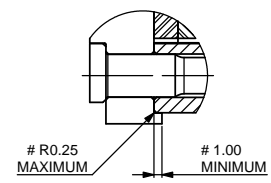

DETAIL B SCALE 2 : 1

**NOTE A :**  
RELEASE TRAVEL TO BE LIMITED TO 5.50mm MAXIMUM.

**NOTE B :**  
INSTALLATION WIRE FOR USE WHEN INSTALLING CLUTCH, TO ENSURE FLYWHEEL SIDE CARBON PLATE IS LOCATED ON THE COVER LUGS.

CLUTCH PART No. SUFFIX	CP7313-CV01-FN (ALUMINIUM COVER)	CP7313-CV13-FN (STEEL COVER)	CP7313-CV29-FN (STEEL COVER)	CP7313-CV13-FP (STEEL COVER WITH CUSHION)	CP7313-CV29-FP (STEEL COVER WITH CUSHION)
MAXIMUM DYNAMIC TORQUE CAPACITY Nm (lb/ft)	1167 (860)	1167 (860)	1167 (860)	1167 (860)	1167 (860)
MAXIMUM WEAR IN #	1.25	1.25	1.25	1.25	1.25
RELEASE LOAD (MAX PEAK WORN) daN	445	445	445	445	445
RELEASE LOAD (AT TRAVEL) daN	375	375	375	375	375
SET UP HEIGHT NEW	43.12	43.12	43.12	43.60	43.60
SET UP HEIGHT WORN	40.31	40.31	40.31	40.69	40.69
SET UP HEIGHT WORN	47.80	47.80	47.80	48.28	48.28

# THIS CLUTCH HAS BEEN DESIGNED FOR THE WEAR INDICATED, WHICH MUST BE COMPENSATED FOR BY USING PRESSURE PLATES FROM EITHER OF THE KITS DETAILED BELOW. MAXIMUM CARBON STACK WEAR IS 6.00mm  
**AXIAL HUB FLOAT MUST BE MAINTAINED**

	PRESSURE PLATE KIT (STEEL)		PRESSURE PLATE FULCRUM KIT	PRESSURE PLATE FULCRUM KIT
STANDARD	CP7313-8 (0.50 - 5.00, 0.50 STEPS)	CP7313-8 (0.50 - 5.00, 0.50 STEPS)	CP7313-8 (0.50 - 5.00, 0.50 STEPS)	CP9033-6 (0.50 - 4.50 (0.50 STEPS)
INTERMEDIATE	CP7313-9 (0.25 - 4.75, 0.50 STEPS)	CP7313-9 (0.25 - 4.75, 0.50 STEPS)	CP7313-9 (0.25 - 4.75, 0.50 STEPS)	CP9033-7 (0.25 - 4.75 (0.50 STEPS)
LOW			CP7313-10 (0.25 - 1.25 (0.25 STEPS)	CP7313-10 (0.25 - 1.25 (0.25 STEPS)
MEDIUM			CP7313-11 (1.50 - 3.00 (0.25 STEPS)	CP7313-11 (1.50 - 3.00 (0.25 STEPS)
HIGH			CP7313-12 (3.25 - 4.75 (0.25 STEPS)	CP7313-12 (3.25 - 4.75 (0.25 STEPS)

HUB DETAILS		
HUB PART No.	SPLINE DETAIL	ØA' MAX
CP4203-102	1.00" x 23	30.25
CP4203-103	0.875" x 20	27.25
CP4203-104	29.0 x 10	34.25
CP4203-110	1 5/32" x 26	30.50

HUBS ARE AVAILABLE WITH OTHER SPLINE SIZES.

ASSEMBLY MASS AND INERTIA			
	ASSEMBLY MASS (kg)	ASSEMBLY INERTIA (kgm <sup>2</sup> )	DRIVEN PLATES & HUB INERTIA (kgm <sup>2</sup> )
ALUMINIUM COVER	3.57	0.0241	0.00472
STEEL COVER	5.28	0.0396	0.00472

BASED ON ASSEMBLY (HIGHEST MASS AND INERTIA IN THIS FAMILY), WITH A STEEL HUB. OTHER VALUES AVAILABLE UPON

Alterations				
Issue No.	Date & No.	Particulars	Zone	Initials
1	05/11/13 C4597	FIRST ISSUE	#	JAS
2	13/01/14 C4597	STEEL COVER OPTION ADDED	#	JG
3	20/04/15	WEAR-IN, 1.25 WAS 1.50	#	JG
4	10/12/15 C4948	CUSHION OPTION ADDED.	#	JG
5	27/05/16 C5046	CP7313-CV29-FN AND FP ADDED. LOW, MED AND HIGH FULCRUM KITS ADDED.	#	JG

SCALE 1:1 SHEET 1 OF 1

DRAWN JOHN SCHOON  
APPROVED #  
DERIVED FROM CP7213CD

TITLE  
Ø200mm CARBON/CARBON  
3 PLATE CLUTCH INSTALLATION

DRG NO. CP7313CD

**THIS WIRE MUST BE REMOVED BEFORE USE.**

# - FLYWHEEL DIMENSIONS.  
ALTERNATIVE CLUTCH MOUNTING: CAP HEAD BOLT (C BORED TREAD) TIGHTENING TORQUE 22.0 Nm (16 lb ft)