

# A0 INSTALLATION DRAWING

IF THIS DOCUMENT IS PRINTED IN HARD COPY, IT IS FOR INFORMATION USE ONLY AND THEREFORE IS NOT SUBJECT TO UPDATING CONTROLS. ALWAYS REFER TO SOLIDWORKS VIEWER FOR LATEST ISSUE



THIS DRAWING IS CONFIDENTIAL AND IS SUPPLIED ON THE EXPRESS CONDITION THAT IT SHALL NOT BE LOANED OR COPIED OR DISCLOSED TO ANY OTHER PERSON OR USED FOR ANY OTHER PURPOSE WITHOUT THE WRITTEN CONSENT OF AP RACING LTD.



AP Racing  
Wheler Road  
Coventry  
CV3 4LB

Tel: +44 (0)24 7663 9595  
Fax: +44 (0)24 7663 9599  
e-mail: sales@apracings.co.uk

© AP Racing Ltd. 2016  
Web site: HTTP://www.apracings.com

Alterations

Date & No.	Particulars	Drawn	Checked
1 25/10/16 R4292	FIRST ISSUE	#	AT
2 06/01/17 R4292	RADIAL PROFILES REFINED (SHEET 2)	#	AT
3 18/05/17 R4292	RETAINER TORQUE UPDATED: WAS 27.1Nm, NOW 19Nm	4M	AT
4 17/07/17 R4292	PART NUMBERING CONVENTION TABLE UPDATED WITH CORRECT PART NO.	1J	AT
5 29/08/18 R4292_17	DRY WEIGHT: 3.28KG ADDED TO CALIPER SPECIFICATION TABLE	3P	SPB

## CALIPER SPECIFICATION

BORE SIZE	JK (38.10 x 41.30) (1.50" x 1.625")
PISTON AREA	24.8cm <sup>2</sup>
DISC DIAMETER MAX	380.00
DISC THICKNESS MAX	28.00
DISC THICKNESS MIN (WORN CONDITION)	26.00 (DIFFERENTIAL WEAR NOT TO EXCEED 0.50mm SIDE TO SIDE)
WORKING PRESSURES	SEE DATA SHEET P14.353 (AVAILABLE FROM AP RACING TECHNICAL DEPT)
HYDRAULIC FEED	M10 x 1.0
DRY WEIGHT (LESS PADS)	3.28kg
PAD FAMILY	CP6600
EFFECTIVE RADIUS (ON DIAMETER 380.00 DISC)	162.50
PL DIMENSION	55.00
OFFSET 'C' DIMENSION	34.00
MOUNTING HOLE CENTRES 'D' DIMENSION	195.00
PAD FRICTION MATERIAL	2 x FRICTION RETAINED PINS
MIN THICKNESS	2.50
PAD RETENTION	BLEED SCREW: 17Nm HYDRAULIC FEED: 25Nm RETAINER BOLTS: 19Nm
TIGHTENING TORQUES	FLUID RESISTANT PAINT FINISH ALUMINIUM BODY BOOT TYPE DIRT SEALS
CORROSION PROTECTION	

## CALIPER POSITIONING

RHT	RIGHT HAND TRAILING (BEHIND AXLE)
LHT	LEFT HAND TRAILING (BEHIND AXLE)
RHL	RIGHT HAND LEADING (IN FRONT OF AXLE)
LHL	LEFT HAND LEADING (IN FRONT OF AXLE)

## PART NUMBERING CONVENTION

PART NUMBER	DESCRIPTION
CP9540-6S0	RHT - SIDE FEED - NO ANTI KNOCK BACK SPRINGS
CP9540-7S0	LHT - SIDE FEED - NO ANTI KNOCK BACK SPRINGS
CP9540-8S0	RHL - SIDE FEED - NO ANTI KNOCK BACK SPRINGS
CP9540-9S0	LHL - SIDE FEED - NO ANTI KNOCK BACK SPRINGS

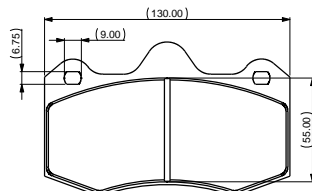

CP6600 PAD FAMILY  
PAD AREA (MAX) 64.6cm<sup>2</sup>

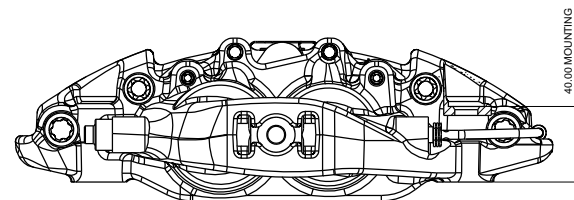
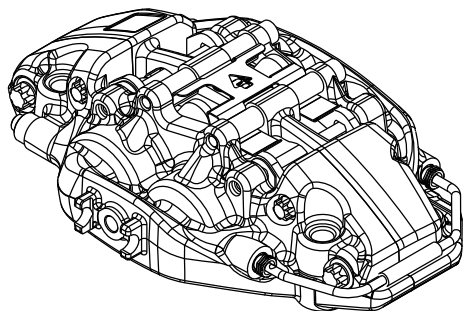
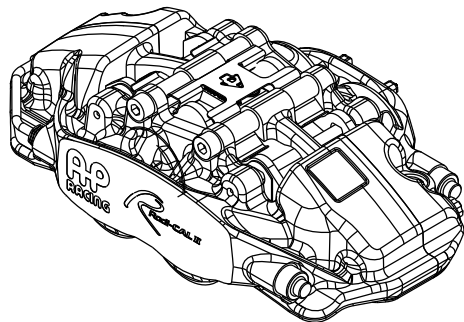
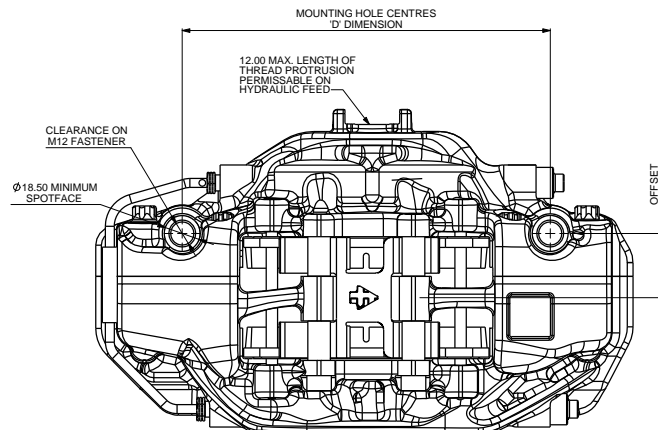
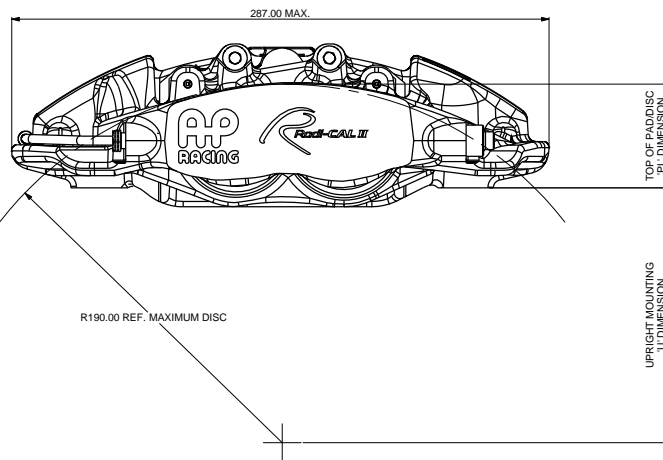

FOR INSTALLED PROFILES SEE SHEET 2

SCALE 1:1 SHEET 1 OF 2

DRAWN ALTHORPE

APPROVED

DERIVED FROM

TITLE

CALIPER INSTALLATION DRAWING

Ø380 x 28 MAX DISC (JK BORES)

DRG NO. cp9540-6cd

# A0 INSTALLATION DRAWING

IF THIS DOCUMENT IS PRINTED IN HARDCOPY, IT IS FOR INFORMATION USE ONLY AND THEREFORE IS NOT SUBJECT TO UPDATING CONTROLS. ALWAYS REFER TO SOLIDWORKS VIEWER FOR LATEST ISSUE

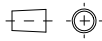

FIRST ANGLE PROJECTION

THIS DRAWING IS CONFIDENTIAL AND IS SUPPLIED ON THE EXPRESS CONDITION THAT IT SHALL NOT BE LOANED OR COPIED OR DISCLOSED TO ANY OTHER PERSON OR USED FOR ANY OTHER PURPOSE WITHOUT THE WRITTEN CONSENT OF AP RACING LTD.



AP Racing  
Wheler Road  
Coventry  
CV3 4LB  
Tel: +44 (0)24 7663 9595  
Fax: +44 (0)24 7663 9559  
e-mail: sales@apracings.co.uk  
© AP Racing Ltd. 2016  
Web site: HTTP://www.apracings.com

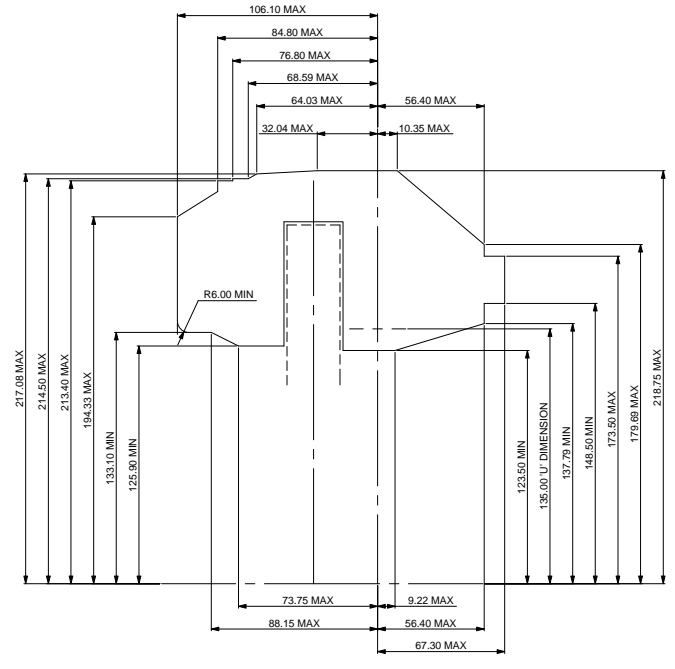

CALIPER INSTALLED PROFILE  
ON  $\phi 380.0 \times 28.00$  DISC

Alterations		Issue
Date & No.	Particulars	Zone
-	SEE SHEET 1 FOR ISSUE INFORMATION.	-

SCALE 1:1	SHEET 2 OF 2
DRAWN	A.THORPE
APPROVED	
DERIVED FROM	
TITLE	
CALIPER INSTALLATION DRAWING	
$\phi 380 \times 28$ MAX DISC (JK BORES)	
DRG NO.	cp9540-6cd