



The Science of Friction

GENERIC MOUNTING BELL WEAR GUIDELINES

The details below provide information on mounting bell wear when fitting to new AP Racing floating brake discs.

MOUNTING BELL WEAR GUIDELINES:

Step 1: Thoroughly clean bell, ensuring slots are free of any dirt/corrosion.

Step 2: Check slot wear and replace bell if wear exceeds specified limit.

Step 3: If wear is below the specified limit install replacement disc in accordance with:

P14.287 - Floating disc generic mounting instructions.

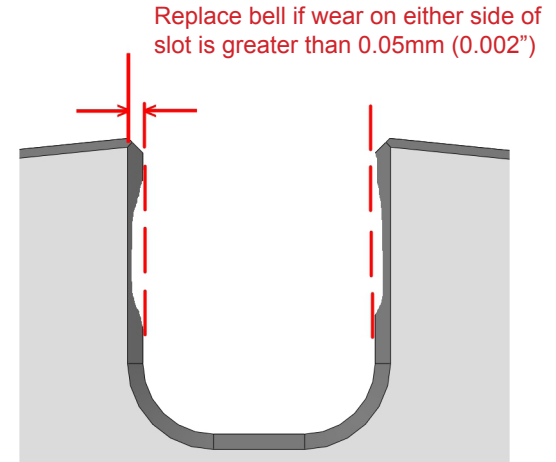
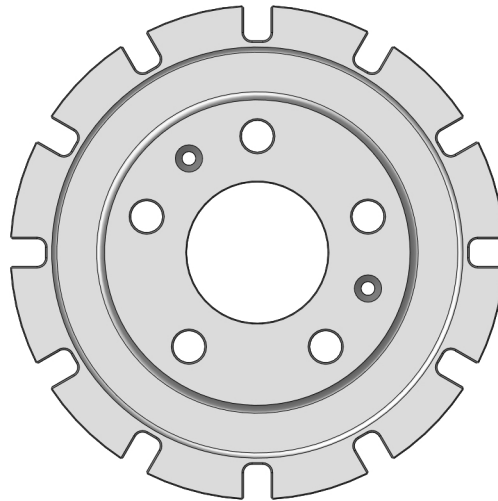

Publication Ref: P14.288 - Issue 1 - 28/11/2011

AP Racing

Wheler Road, Coventry, CV3 4LB, United Kingdom

Tel: +44 (0)54 7663 9595 Fax: +44 (0)24 76639559 e-mail: sales@apracings.co.uk Web: www.apracings.com

Every effort has been made to ensure the information contained in this publication is correct at the time of printing, the company however cannot except ant responsibility for any errors or changes that may occur.