

# B1 INSTALLATION DRAWING

IF THIS DOCUMENT IS PRINTED IN HARDCOPY, IT IS FOR INFORMATION USE ONLY AND THEREFORE IS NOT SUBJECT TO UPDATING CONTROLS. ALWAYS REFER TO SOLIDWORKS VIEWER FOR LATEST ISSUE

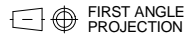

THIS DRAWING IS CONFIDENTIAL AND IS SUPPLIED ON THE EXPRESS CONDITION THAT IT SHALL NOT BE LOANED OR COPIED OR DISCLOSED TO ANY OTHER PERSON OR USED FOR ANY OTHER PURPOSE WITHOUT THE WRITTEN CONSENT OF AP RACING LTD.



**AP Racing**  
Wheler Road  
Coventry  
CV3 4LB  
Tel: +44 024 7663 9595  
Fax: +44 024 7663 9559  
e-mail: sales@apracing.co.uk  
Web site: HTTP://www.apracing.com

**GENERAL DESCRIPTION**  
6 PISTON DIFFERENTIAL BORE CALIPER TO SUIT UP TO A  $\phi 390\text{mm} \times 35.56\text{mm}$  MAX / 32mm MIN THICK IRON DISC. PADS ARE RETAINED BY A BOLTED RETAINER. WITH A QUICK-RELEASE SPRING CLIP SUPPLIED FOR USE IN EVENTS WHEN FAST PAD CHANGES ARE REQUIRED.

**APPLICATION**  
GENERAL USE CALIPER

**TECHNICAL INFORMATION**  
TOTAL PISTON AREA: 50cm<sup>2</sup>  
BODY MATERIAL: ALUMINIUM ALLOY  
PISTON MATERIAL: STAINLESS STEEL

ASSEMBLY WEIGHT (LESS PADS, BOLTED PAD RETAINER): 3.1Kg

**INSTALLATION INFORMATION**  
DISC & CALIPER MOUNTING TOLERANCES TO BE SUCH THAT THE DISC IS CENTRAL TO THE CALIPER TO WITHIN  $\pm 0.5\text{mm}$ .  
DISC DIAMETRAL CLEARANCE SHOULD BE 2.5mm NOMINAL FROM DISC O/D TO PATHWAY.

**KEY TO DIMENSIONS**  
'PL' DIMM : TOP OF PAD MATERIAL TO MOUNTING BOSS FACE.  
'U' DIMM : WHEEL CENTRE LINE TO CALIPER MOUNTING BOSS FACE = (DISC  $\phi/2$ ) - PL DIMM

**CALIPER PART NUMBERS**  
CP9665-2S7L - RIGHT HAND  
CP9665-3S7L - LEFT HAND

EXAMPLE PART # - CP9665-2 S (SIDE FEED) 7 (7lb AKB SPRINGS) L (STAINLESS PISTONS).

**PADS**  
THE CORRECT PAD FAMILY FOR THIS CALIPER IS CP6230D54. PADS SHOULD BE ORDERED SEPERATELY.

**RECOMMENDED DISC AND PAD OPTIONS AVAILABLE**  
D54 DISC AND PAD COMBINATION

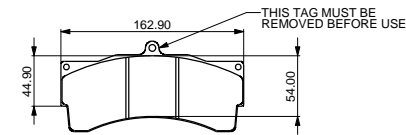

**CP6230D54 PAD FAMILY**  
PAD AREA - 81.6cm<sup>2</sup>  
VOLUME - 164.3cm<sup>3</sup>  
THICKNESS - 25.00mm

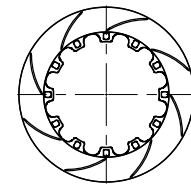

**CP4284-134/5CG8**  $\phi 390 \times 36$  12F 84v 8.7Kg  
**CP5772-1030/1CG8**  $\phi 378 \times 32$  12I 72v 7.2Kg

**OPTIMUM BLEED POSITIONING**  
FOR OPTIMUM BLEED, THE CALIPER SHOULD BE INSTALLED IN THE LEADING OR TRAILING POSITION, BETWEEN THE ANGLES SHOWN.

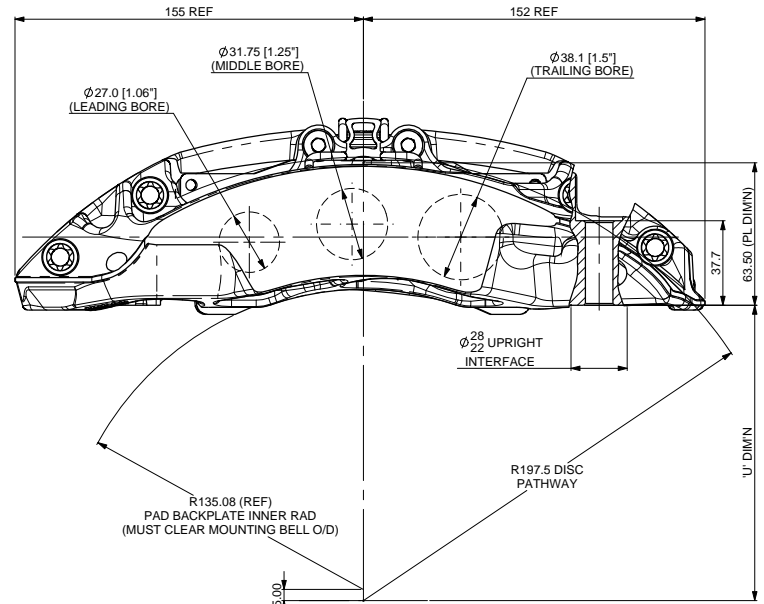
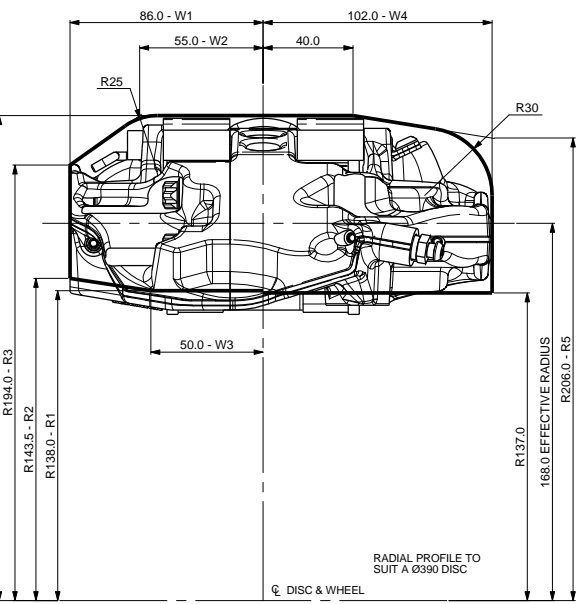
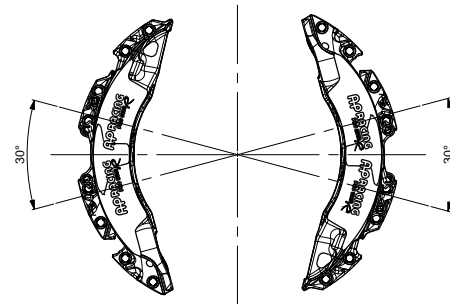

DISC $\phi$	EFF RAD	R1	R2	R3	R4	R5	W1	W2	W3	W4
378	162	132.00	137.50	188.50	210.50	201.00	86.00	55.00	50.00	102.00

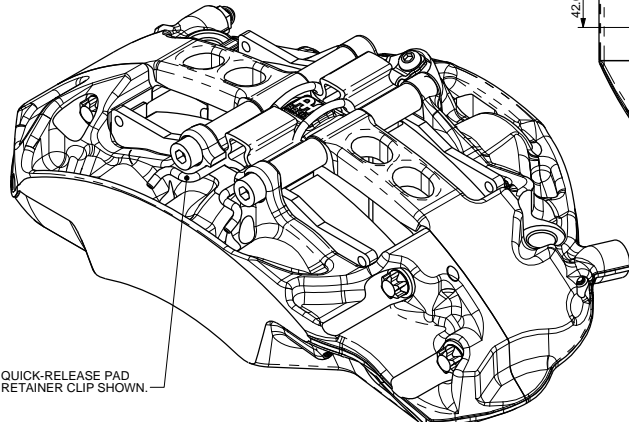
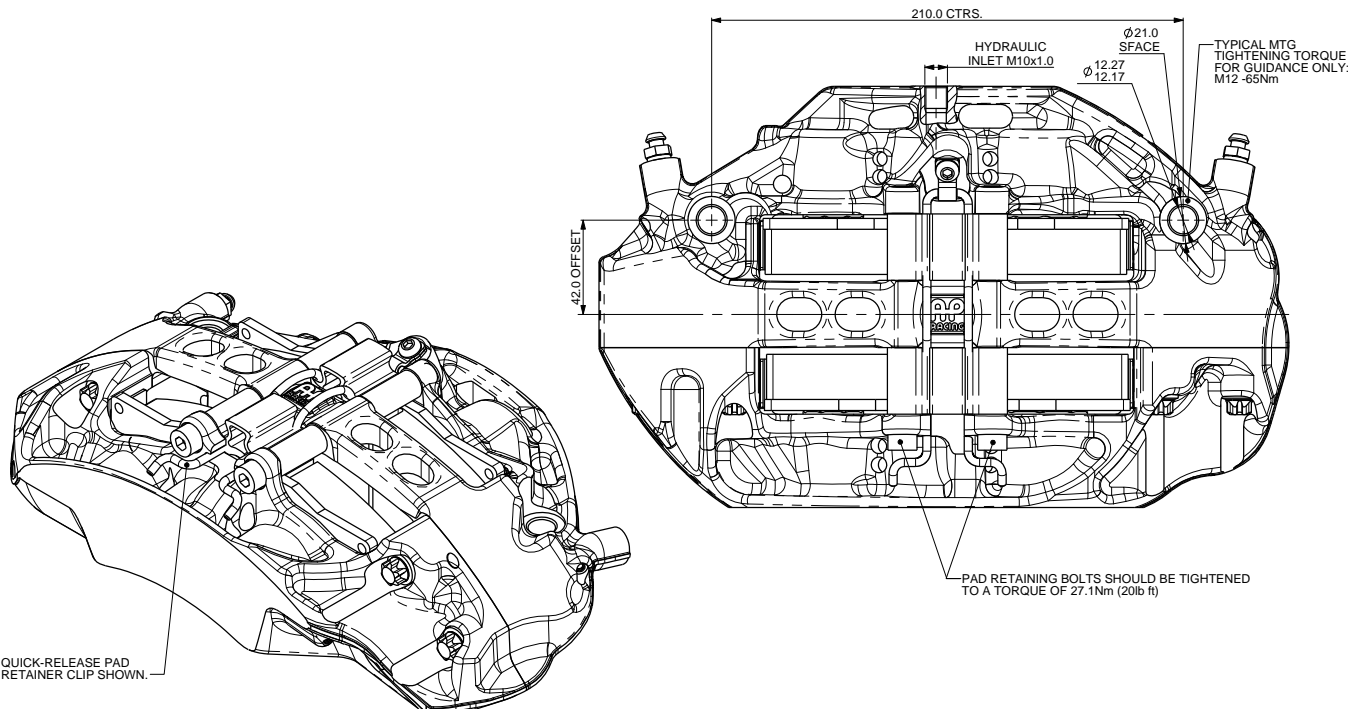

Issue No	Alterations			Zone	Initials
	Date & No.	Particulars			
1	24 JUN 14 B7060	FIRST ISSUE			JT
2	9 JUL 14 B7060	7lb AKB SPRINGS WERE 4lb.			JT
3	25 JUL 14 B7060	DRAWING NUMBER CORRECTED.			JT
4	18 SEPT 14 B7060	32mm MINIMUM DISC OPTION ADDED.			JT
5	20/11/14 B7060	DISC AND PAD OPTIONS ADDED CP9665-12-3 RETAINER KITS ADDED			CH
6	20/11/14 B7060	RADIAL PROFILE UPDATED RADIAL PROFILE TABLE ADDED DISC OPTIONS UPDATED			CH
7	13/01/15 B7060	SPARES LIST UPDATED TO INCLUDE CORRECT WEAR PLATES			CH
8	14/01/15 B7060	NOTE FOR PAD TAG REMOVAL ADDED GRAPHICAL CHANGE TO MOUNTING BOSS AREA.			CH
9	13/09/16 B7623	MTG. HOLE DIA. CORRECTED FROM 12.3/12.2, NOW 12.27/12.17			CH
10	17/07/2017 B7726.01	ADDED TORQUE SPECIFICATIONS TO PAD RETAINING BOLTS			C10 SGW

SCALE 1:1	SHEET 1 OF 2
DRAWN Jon Tait	
APPROVED	
DERIVED FROM	
TITLE 6 POT PRO5000 R CALIPER INSTALLATION	
DRG NO.	CP9665-1CD

B1

INSTALLATION DRAWING

IF THIS DOCUMENT IS PRINTED IN HARDCOPY, IT IS FOR INFORMATION USE ONLY AND THEREFORE IS NOT SUBJECT TO UPDATING CONTROLS. ALWAYS REFER TO SOLIDWORKS VIEWER FOR LATEST ISSUE



THIS DRAWING IS CONFIDENTIAL AND IS SUPPLIED ON THE EXPRESS CONDITION THAT IT SHALL NOT BE LOANED OR COPIED OR DISCLOSED TO ANY OTHER PERSON OR USED FOR ANY OTHER PURPOSE WITHOUT THE WRITTEN CONSENT OF AP RACING LTD.



AP Racing  
Wheler Road  
Coventry  
CV3 4LB  
Tel: +44 024 7663 9595  
Fax: +44 024 7663 9550  
e-mail: sales@apracings.co.uk  
Web site: HTTP://www.apracings.com

PAD RETAINER KIT - CP9665-12			
REF.	DESCRIPTION	PART NO.	QTY
8a	PAD RETAINER	CP9665-119	2
8b	M8 CAP SCREW	CP3715-117ST	2

QUICK RELEASE RETAINER KIT - CP9665-13			
REF.	DESCRIPTION	PART NO.	QTY
9a	PAD RETAINER CLIP	CP9665-118	1
9b	RETAINER HINGE	CP6268-110	1
9c	SCREW M6x12	CP3160-106ST	1

CP9665-2/3S7L SPARES				
REF	DESCRIPTION	PART NO.	QTY / ASSY	FITTING INSTRUCTIONS
1	Ø1.06 SST PISTON 33.1 LONG	CP9665-114	2	
2	Ø1.25 SST PISTON 33.1 LONG	CP9665-115	2	
3	Ø1.5 SST PISTON 33.1 LONG	CP9665-116	2	
4	SEAL KIT (6 SEALS)	CP8518-CEJ	1	REFER TO PUBLICATION REF: P14.290 & P14.220
5	BLEED SCREW KIT	CP3880-1	1	TIGHTENING TORQUE - 17Nm
6	M5 BUTTON SCREW	CP9440-116ST	4	APPLY A 1-2MM DROP OF LOCTITE 270 TO THE 2ND FROM LAST THREAD WHEN FITTING. TIGHTENING TORQUE - 3.7Nm
7	PAD WEAR PLATE	CP9665-112 RH CP9665-113 LH	2 2	APPLY 736 RTV SILICONE SPARINGLY BEHIND THE ABUTMENT PLATE ENSURING ENTIRE CONTACT FACE IS COVERED APPLY PRESSURE TO ABUTMENT PLATE WHEN FITTING TO ENSURE MINIMUM FILM THICKNESS AND AVOID ANY GAP ENSURE ABUTMENT PLATE SITS CORRECTLY AGAINST CALIPER BODY BEFORE FITTING RETAINING SCREWS
10	7Lb AKB SPRING KIT	CP6518-7LBSSL	1	

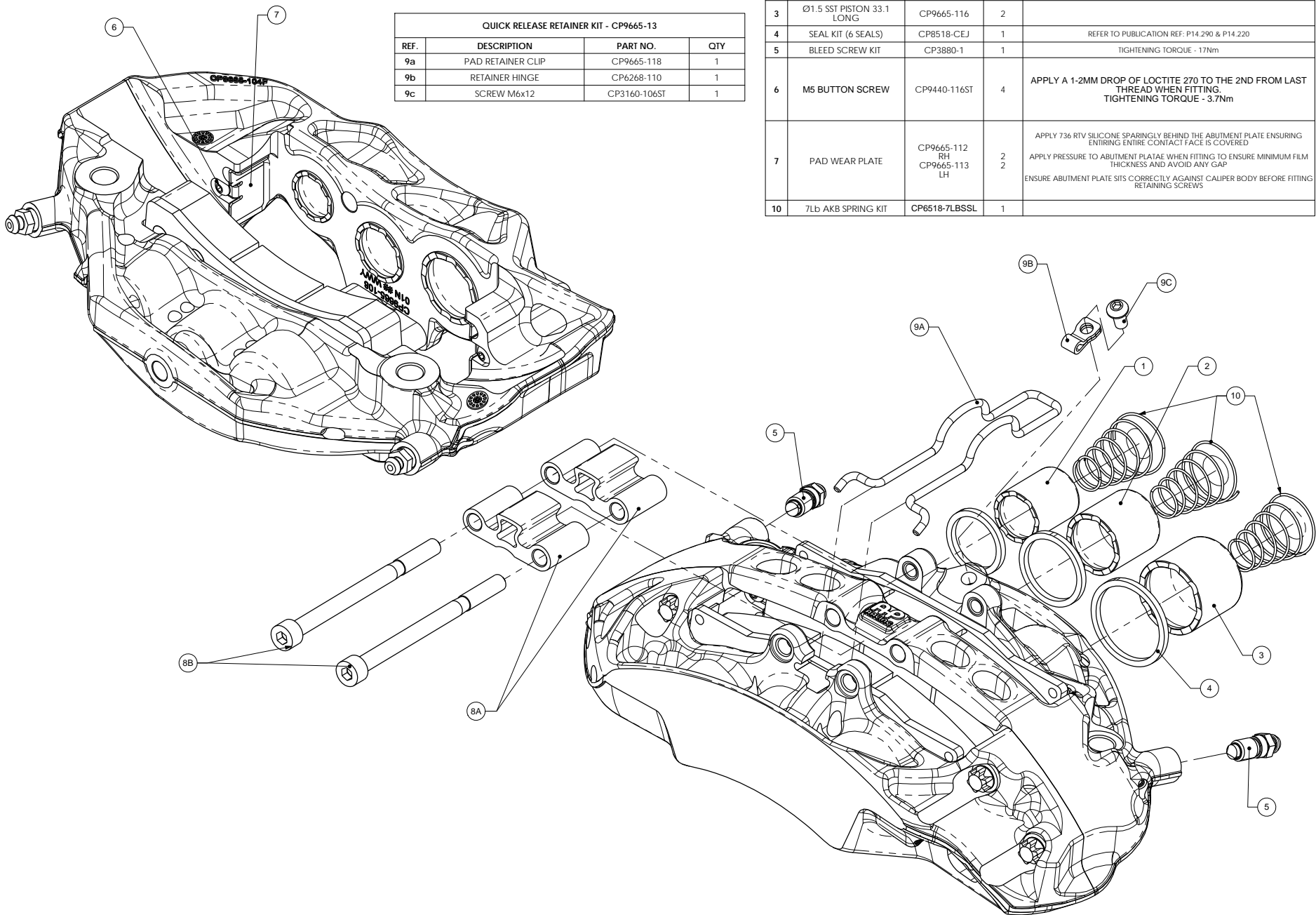

Issue No.	Alterations			Zone	Initials
	Date & No.	Particulars			
-	-	SEE SHEET1 FOR ISSUE INFORMATION.	-	-	-

SCALE 1:5 SHEET 2 OF 2

DRAWN Jon Tait

APPROVED

DERIVED FROM

TITLE  
6 POT PRO5000 R  
CALIPER INSTALLATION

DRG NO. CP9665-1CD